WINCHESTER[®]

**IMPORTANT SUPPLEMENTARY
INSTRUCTIONS FOR
Model 1886
TAKEDOWN
LEVER ACTION RIFLE**



WINCHESTER[®]
RIFLES AND SHOTGUNS

U.S. REPEATING ARMS COMPANY, INC.

344 Winchester Avenue
New Haven, CT, U.S.A. 06511-1970
www.winchester-guns.com

These are special instructions for the Winchester Model 1886 Takedown version only. These instructions must be used in conjunction with the instructions in the full Model 1886 Owner's Manual. If your manual is missing please contact U.S. Repeating Arms immediately to obtain a new manual free of charge. Phone numbers and addresses are contained inside this manual.

U.S. REPEATING ARMS COMPANY, INC.

344 Winchester Avenue
New Haven, CT, U.S.A. 06511-1970

Administrative Offices:
275 Winchester Avenue,
Morgan, UT, U. S. A. 84050-9333

Winchester trademarks licensed from Olin Corporation.

WINCHESTER®

New gun owner's record.

Use the space below to record information about your new Winchester firearm.

Serial Number _____

Caliber _____

Grade _____

Purchase Price _____

Purchased From _____

Date of Purchase _____

Winchester trademarks licensed from Olin Corporation

PRINTED IN U.S.A. • ©1999 • KP99011.5 / 98375

WINCHESTER®

SPECIAL WARNINGS FOR
THE TAKE-DOWN MODEL 1886

IT IS ESSENTIAL THAT THESE OPERATING INSTRUCTIONS AND THE INSTRUCTIONS / WARNINGS PROVIDED IN THE MODEL 1886 OWNER'S MANUAL BE THOROUGHLY STUDIED BEFORE USING THIS FIREARM TO ASSURE PROPER AND SAFE GUN HANDLING. FAILURE TO FOLLOW THESE INSTRUCTIONS OR FAILURE TO OBEY ANY SAFETY WARNING MAY RESULT IN INJURY TO YOURSELF OR OTHERS, OR CAUSE DAMAGE TO YOUR GUN.

IF YOUR MODEL 1886 OWNER'S MANUAL IS MISSING YOU MUST OBTAIN ONE FROM YOUR DEALER OR US BEFORE USING YOUR NEW RIFLE.

As a gun owner, you accept a set of demanding responsibilities. How seriously you take these responsibilities can be the difference between life and death. There is no excuse for careless or abusive handling of any firearm. At all times handle your rifle and any other firearm with intense respect for its power and potential danger.

PLEASE READ AND UNDERSTAND ALL OF THE CAUTIONS, PROPER HANDLING PROCEDURES AND INSTRUCTIONS OUTLINED IN THIS BOOKLET BEFORE USING YOUR NEW FIREARM.

THE BARREL HALF OF YOUR RIFLE IS DESIGNED AND MADE FOR ONLY THE RECEIVER IT WAS SHIPPED WITH. BARRELS AND RECEIVERS ARE NOT INTERCHANGEABLE. NEVER ATTEMPT TO USE THE BARREL FROM ONE MODEL 1886 TAKE-DOWN ON ANOTHER RIFLE.

DISCHARGING FIREARMS IN POORLY VENTILATED AREAS, CLEANING FIREARMS, OR HANDLING AMMUNITION MAY RESULT IN EXPOSURE TO LEAD AND OTHER SUBSTANCES KNOWN TO CAUSE BIRTH DEFECTS, REPRODUCTIVE HARM AND OTHER SERIOUS PHYSICAL INJURY. HAVE ADEQUATE VENTILATION AT ALL TIMES. WASH HANDS THOROUGHLY AFTER EXPOSURE.

GENERAL DESCRIPTION

Your new Model 1886 has unique features found only on the takedown model. The primary difference is the addition of a mechanism that allows you to separate the barrel/forearm half of the rifle from the receiver half of the rifle. The takedown design utilizes an interrupted thread system on the barrel extension and receiver, and a special mechanism on the end of the magazine tube which allows you to disengage the barrel from the receiver.

ALL OTHER GENERAL INSTRUCTIONS AND WARNINGS ARE THE SAME AS FOUND IN THE MODEL 1886 OWNER'S MANUAL. IF YOUR MANUAL IS MISSING PLEASE CONTACT US IMMEDIATELY FOR A FREE COPY — BEFORE ATTEMPTING TO USE YOUR NEW RIFLE.

YOU MUST REFER TO YOUR MODEL 1886 OWNER'S MANUAL FOR DETAILS ON THE SAFETY AND OTHER FEATURES FOUND ON YOUR NEW MODEL 1886.

TERMINOLOGY AND DESCRIPTIONS

Descriptions in this manual generally refer to the gun in the horizontal position — in the normal firing position. For example, the muzzle is forward or front; the butt stock is rearward or rear; the trigger is downward or

FIGURE 1-A

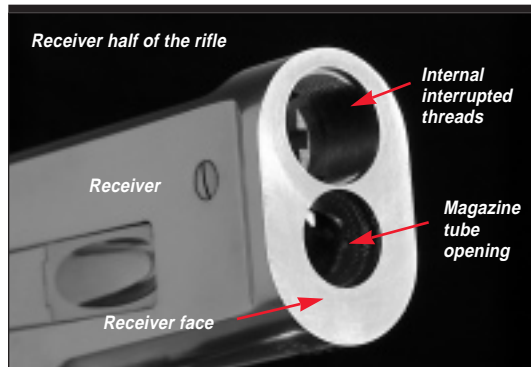

FIGURE 1-B

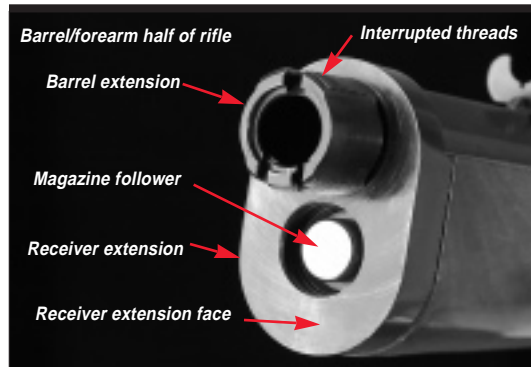

FIGURE 1-C

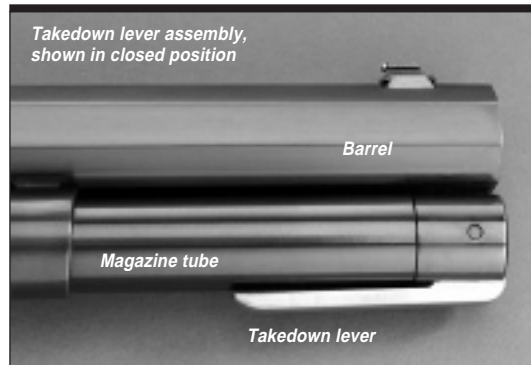
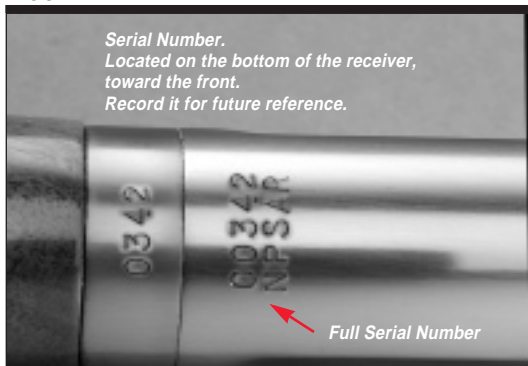

FIGURE 2



underneath; the sight is upward or on top. For terminology related to the takedown feature of this rifle, refer to Figures 1A - C. Throughout this manual the “action” refers to the mechanism of this rifle which loads and secures the cartridge in the chamber.

The takedown system utilizes a threaded barrel extension with interrupted threads, which allows the barrel to be attached to the receiver with merely a 90° turn. The barrel is locked in place in the receiver with a special, retracting magazine tube design that is operated using a lever on the front end of the magazine tube.

SERIAL NUMBER

The full serial number is located on the receiver half of the rifle, on the bottom of the receiver, toward the front (see Figure 2). The last four digits of the number portion of the serial number are also on the receiver extension just forward of where it mates with the receiver. Record the full serial number at the front of this book for future reference.

THE BARREL MUST ONLY BE USED WITH THE SAME RECEIVER IT WAS SOLD WITH. BARRELS ARE NOT INTERCHANGEABLE WITH ANY CURRENT OR OLDER MODEL 1886 TAKEDOWN RIFLE.

TAKEDOWN PROCEDURE

When your rifle is fully assembled use this procedure to take it down into its two parts.

COMPLETELY UNLOAD YOUR RIFLE BY REMOVING ALL CARTRIDGES FROM THE MAGAZINE, CHAMBER AND FEED AREAS AS EXPLAINED IN YOUR MODEL 1886 MANUAL. MAKE SURE YOUR RIFLE IS POINTED IN A SAFE DIRECTION.

TAKING DOWN YOUR RIFLE WITH A CARTRIDGE IN THE MAGAZINE IS NOT ONLY DANGEROUS, IT WILL ALSO PREVENT DISASSEMBLY.

PLACE THE SAFETY IN THE “ON SAFE” POSITION. PLACE YOUR RIFLE OVER A PADDED SURFACE ON A TABLE, WORK BENCH OR OTHER SUITABLE LOCATION TO PREVENT DROPPING IT DURING DISASSEMBLY.

FIGURE 3



WINCHESTER

1. Open the bolt completely by working the finger lever downward and fully forward as explained in your Model 1886 owner's manual. The barrel will not separate from the receiver unless the action is opened. Failure to do this can damage bolt components if you attempt to remove the barrel by force with the bolt is closed.
2. Open the takedown lever on the end of the magazine tube by lifting it fully outward, away from the magazine (see Figure 3).
3. Looking from the muzzle end of the rifle, rotate the lever counterclockwise at least five full turns (see Figure 4).
4. Hold your rifle in shooting position (one hand hold the receiver of the rifle and the other holding the forearm). Grasp the barrel half firmly with one hand and the receiver firmly with the other.
5. With the rifle oriented with you looking from the receiver toward the barrel, turn the barrel assembly clockwise 90 degrees (see Figure 5).

This unlocks the barrel threads from the matching threads in the receiver.

6. Pull the barrel forward, removing the threaded barrel extension from the receiver (see Figure 6).

FIGURE 4



6

WINCHESTER

FIGURE 5



FIGURE 6



7

WARNING: IF THE BARREL SECTION WILL NOT TURN WITH RESPECT TO THE RECEIVER DO NOT APPLY EXTRA FORCE UNTIL YOU CHECK AGAIN TO MAKE SURE YOU HAVE FIRST OPENED THE ACTION AND THAT THE TAKEDOWN LEVER ON THE END OF THE MAGAZINE HAS BEEN SUFFICIENTLY TURNED TO DISENGAGE THE MAGAZINE TUBE AND FOLLOWER FROM THE RECEIVER. APPLYING UNDUE FORCE WITH THE BOLT STILL LOCKED IN THE ACTION COULD DAMAGE THE ACTION.

(If the two halves will not turn with respect to each other as explained, also loosen the release lever another turn or two until the halves will turn and separate. The magazine tube and follower must be turned into the receiver extension sufficiently to clear the front surface of the receiver.)

7. The barrel is now removed from the receiver and you are holding the two halves of your rifle. Your rifle is now fully taken down (refer to Figure 7).

8. To case or store your rifle in the two halves first return the takedown lever to its normal position, flush with the bottom of the magazine, centered on the bot-

FIGURE 7



tom of the magazine tube. Then close the the bolt by working the finger lever rearward then upward.

YOU MUST AVOID INADVERTENTLY ATTEMPTING TO TAKEDOWN THE RIFLE WITH THE ACTION CLOSED. THIS CAN CAUSE DAMAGE TO THE BOLT OR OTHER COMPONENTS.

RE-ASSEMBLY PROCEDURE

If your rifle is taken-down into its two component parts follow these instructions for re-assembly and for preparing your rifle for use.

MAKE SURE YOUR RIFLE IS COMPLETELY UNLOADED. ASSURE THAT ALL CARTRIDGES ARE REMOVED FROM THE MAGAZINE, CHAMBER AND FEED AREAS AS EXPLAINED IN YOUR MODEL 1886 MANUAL. MAKE SURE YOUR RIFLE'S MUZZLE IS POINTED IN A SAFE DIRECTION.

PLACE THE SAFETY IN THE "ON SAFE" POSITION.

1. Open the action completely by lowering the finger lever and positioning it fully forward as explained in

FIGURE 8

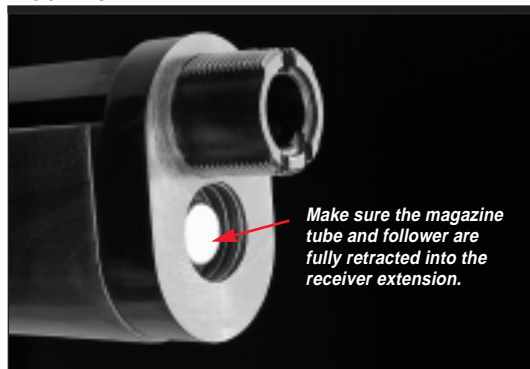

your Model 1886 owner's manual.

2. Pull the takedown lever fully downward (refer back to Figure 3). Double check to make sure the magazine tube and follower are not protruding from the receiver extension (see Figure 8). If the magazine tube and follower protrude, retract them completely as explained under Step 3 of the instructions under "Takedown Procedure."
3. Hold the receiver half of the rifle in one hand and the barrel half in the other.
4. Position the receiver half in normal shooting position (top of the receiver upward) and position the barrel half rotated slightly until the bottom of the forearm is on the left side, angled at approximately 90 degrees.
5. Insert the threaded barrel extension fully into the receiver. The interrupted threads on both the barrel extension and in the receiver allow you to insert the barrel into the receiver.

Insert the barrel extension until the faces on the receiver half and the barrel half are very close together . . . lightly touching. At this point the barrel is fully inserted.

FIGURE 9



6. With the barrel extension inserted, turn the barrel counterclockwise 90° to tighten the connection (see Figure 9). Very little force should be required to turn the barrel assembly into its proper position.

WARNING: IF THE BARREL SECTION WILL NOT TURN WITH RESPECT TO THE RECEIVER DO NOT APPLY EXTRA FORCE UNTIL YOU CHECK AGAIN TO MAKE SURE YOU HAVE FIRST OPENED THE ACTION FULLY AND THAT THE MAGAZINE TUBE AND FOLLOWER ARE FULLY RETRACTED. APPLYING FORCE WITH THE BOLT STILL CLOSED IN THE ACTION COULD DAMAGE THE ACTION.

ALSO MAKE CERTAIN THE MAGAZINE WAS FULLY UNLOADED. A CARTRIDGE IN THE MAGAZINE WHEN TAKING DOWN YOUR RIFLE IS NOT ONLY DANGEROUS, IT WILL ALSO PREVENT DISASSEMBLY.

If it still will not turn, check to make sure there is no foreign matter (dirt, grit, etc.) between the faces on the receiver and barrel halves. Wipe clean and lightly oil. Retract the magazine tube and follower one or two more turns. Try again.

7. With the two halves properly in place, tighten the locking lever fully by turning it fully closed. By doing this you are turning the magazine tube back into the matching recess in the receiver. Visually, the turn direction is counterclockwise when viewed from the receiver, or clockwise when viewed looking down toward the muzzle.
8. Be sure to fully tighten the locking lever. Fold the locking lever over until it lays along the bottom of the magazine tube (see Figure 10). The locking lever may be

FIGURE 10



Tighten the locking lever fully then lay it down in its normal position along the bottom of the magazine tube.

slightly off-center with respect to the bottom of the magazine tube when fully tightened. This is not a problem. Simply rotate it into alignment. Your rifle is now fully reassembled.

ORDERING PARTS

To order parts, please write our parts department and furnish the following: your name, address, and telephone number. Also specify the model and serial number of your gun. When we receive your request, we will send an order form and a parts breakdown with prices.

Write to:

Parts Department
U.S. Repeating Arms Company, Inc.
275 Winchester Avenue
New Haven, Connecticut 06511-1970

CAUTION: PARTS ARE MADE FOR WINCHESTER BRAND FIREARMS MANUFACTURED BY OR FOR U.S. REPEATING ARMS COMPANY, INC., AND SHOULD NOT BE USED IN OTHER GUNS EVEN THOUGH MODELS MAY BE SIMILAR. IMPROPERLY FITTED PARTS MAY BE DANGEROUS.

SERVICE OR REPAIR

If your Winchester firearm should ever need repair or service, please utilize one of the world-wide network of U.S. Repeating Arms Company Authorized Repair Centers for Winchester firearms. A list of ARCs is packaged with your new gun. If you need to obtain a new list of ARCs call us at:

1-203-789-5000

QUESTIONS

If you have other questions about Winchester rifles and shotguns, call or write our Customer Service Department:

Customer Service
U.S. Repeating Arms Company, Inc.
275 Winchester Avenue
Morgan, Utah 84050-9333
Phone: 1-800-945-5237

WINCHESTER-GUNS.COM

U.S. Repeating Arms Company offers an information resource for you on the world wide web.

- List of authorized repair centers.
- Customer service information.
- Answers to many technical and historical questions.
- Links to helpful sites.

www.winchester-guns.com