

Panasonic

2.4GHz Digital Cordless Phone

Operating Instructions

Model No. **KX-TG2208B**

Pulse-or-tone dialing capability



**PLEASE READ BEFORE
USE AND SAVE.**

**Charge the battery for about
6 hours before initial use.**

Contents by Section

- 1 Getting Started
- 2 Making/Answering Calls
- 3 Special Features
- 4 Things You Should Know
- 5 Guía rápida

Panasonic World Wide Web address:

<http://www.panasonic.com>

for customers in the USA or Puerto Rico

Attach your purchase receipt here.

For your future reference

Serial No. _____

Date of purchase _____

(found on the bottom of the unit)

Name and address of dealer _____

For product service

- Call 1-800-211-PANA(7262) or 1-800-833-9626 for the location of an authorized servicerenter.
- Panasonic's e-mail address for customer inquiries:
consumerproducts@panasonic.com
for customers in the USA or Puerto Rico ONLY

When you ship the product

- Carefully pack your unit, preferably in the original carton.
- Attach a letter, detailing the symptom, to the outside of the carton.

Symptom _____

- Send the unit to an authorized servicerenter, prepaid and adequately insured.
- Do not send your unit to the Panasonic Consumer Electronics Company listed below or to executive or regional sales offices. These locations do not repair consumer products.

**If you need assistance with the set-up or operation,
please call 1-800-211-PANA(7262)**

**Panasonic Consumer Electronics Company,
Division of Matsushita Electric Corporation of America**
One Panasonic Way, Secaucus, New Jersey 07094

**Panasonic Sales Company,
Division of Matsushita Electric of Puerto Rico, Inc.**
Ave. 65 de Infantería, Km. 9.5, San Gabriel Industrial Park
Carolina, Puerto Rico 00985

PQQX13574YA F0103-1033 ©

1-A Accessories

- AC Adaptor. one
Order No.
PQLV19Z
(PQLV19)
- Telephone Line Cord one
Order No.
PQJA10075Z
- Battery one
Order No.
N4HHEPA00001
(HHR-P513)
- Handset Cover one
Order No.
PQKK10136Z2
- Belt Clip one
Order No.
PQKE10361Z2
- Shoulder Rest Attachment one
Order No.
PQKE10364Z1

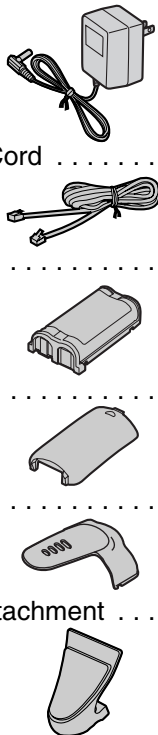

1-B Location of Controls

Handset

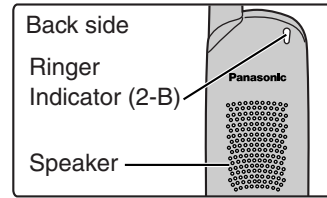

Talk/Ringer Indicator (2-A, 2-B)

RECHARGE Indicator (4-A)

[] (TALK/Channel) (2-A)

[**SP-PHONE**] (Speakerphone/Channel) (2-A)

Headset Jack (4-D)

[*] (TONE) (3-C)

[**FLASH/CALL WAIT**] (3-D)

Microphone (2-A)

Charge Contacts (4-A)

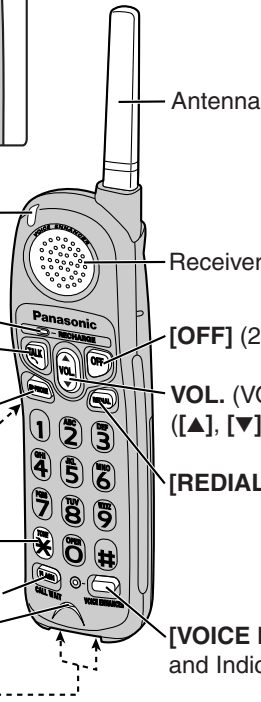

Base unit

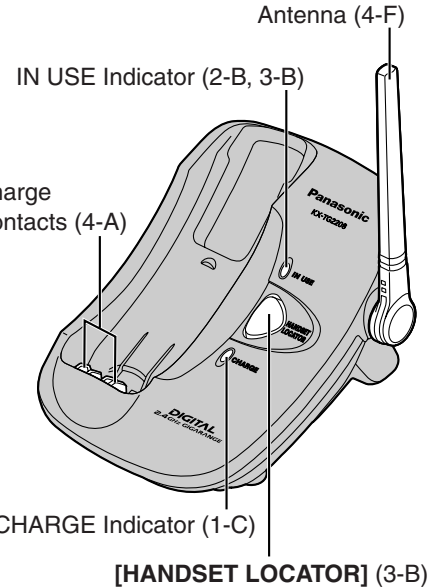

•For extra orders, call 1-800-332-5368.

1-C Settings

1 Connect as shown.

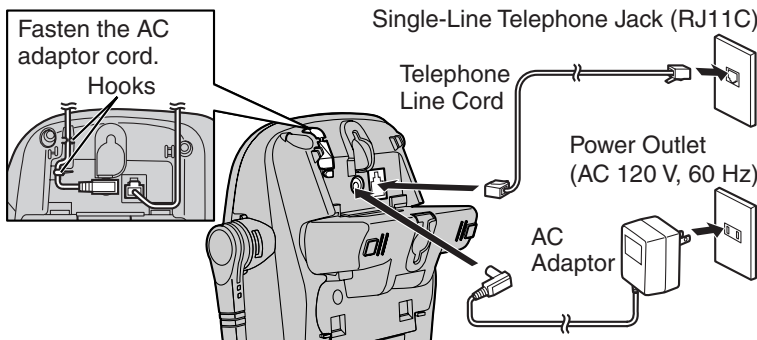

- USE ONLY WITH Panasonic AC ADAPTOR PQLV19 (Order No. PQLV19Z).
- The AC adaptor must remain connected at all times. (It is normal for the adaptor to feel warm during use.)
- The unit will not work during a power failure. To connect a standard telephone on the same line, use the Panasonic T-adaptor KX-J66.

To select the dialing mode TONE (preset) or PULSE

You can program the dialing mode using the handset near the base unit. Make sure the unit is not being used and the handset is lifted off the base unit before programming.

While pressing [**FLASH/CALL WAIT**]:

Press and hold [#] (PULSE) until the unit beeps.

OR

Press and hold [*] (TONE) until the unit beeps.

- If 3 beeps sound during programming, walk closer to the base unit and start again from the beginning.

2 Insert the battery (1), and press it down until it snaps into the compartment (2). Close the cover.

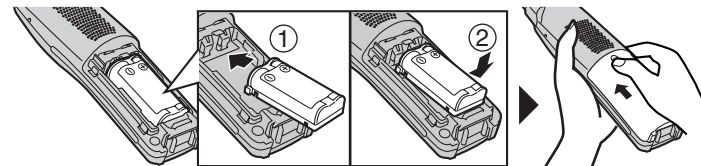

To replace the battery:

Press the notch on the cover firmly and slide it as indicated by the arrow. Replace the old battery with a new one (4-A). Close the cover and charge the battery for about 6 hours.



3 Charge the battery for about 6 hours.

- See section 4-A for more details.
- The CHARGE indicator lights and the unit beeps once.
- It is normal for the back on the handset to feel warm during battery charge.

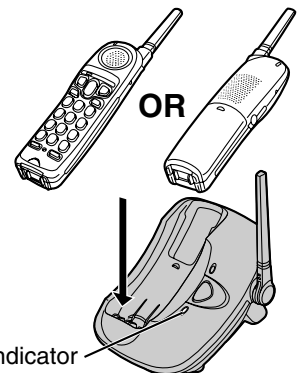

CHARGE indicator

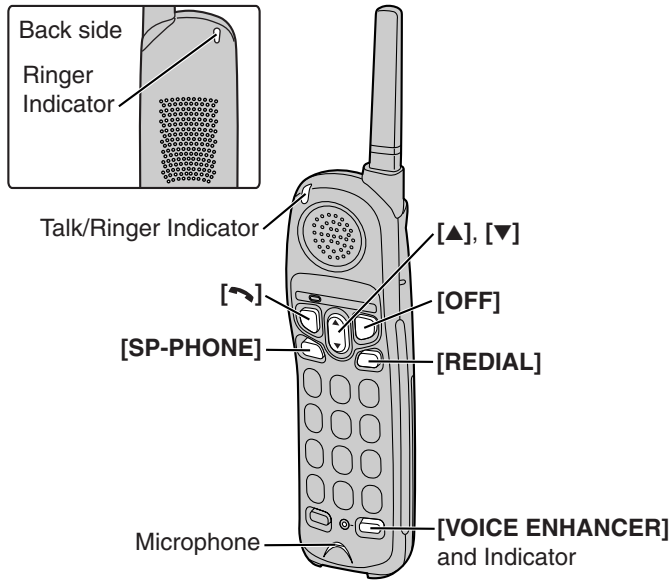

Voice Enhancer Technology

Voice Enhancer Technology helps clarify and improve sound reception creating a natural-sounding voice that is easy to hear and understand.

This is accomplished by enhancing the frequency that is narrowed through the telephone line and comes pre-set to ON at the factory.

- When the mode is set to ON, the VOICE ENHANCER indicator lights in talk or speakerphone mode.

Helpful hint:

Depending on the condition and quality of your telephone line, Voice Enhancer may emphasize the noise already on the line. If it becomes difficult to hear the caller, please set Voice Enhancer mode to OFF. Each time you press [VOICE ENHANCER] while talking, the mode will change to ON or OFF.

2-A Making Calls

- 1 Press [↶] then dial a phone number.
OR
To have a hands-free phone conversation, press [SP-PHONE] and dial a phone number. When the other party answers, talk into the microphone.
 - The Talk/Ringer indicator lights.
 - If an alarm tone sounds, see section 4-H.

- 2 To hang up, press [OFF] or place the handset on the base unit.
 - The indicator light goes out.

- For the best operating performance, see section 4-F.

To redial the last number dialed

Press [↶] or [SP-PHONE], then press [RE-DIAL].

To adjust the receiver/speaker volume while talking

3 levels (HIGH, MEDIUM and LOW) are available for the receiver and 6 levels for the speaker.

To increase volume, press [▲]. To decrease volume, press [▼].

- If you try to increase/decrease volume when it is at the maximum/minimum level, 3 beeps will sound.

If noise interferes with the conversation

Have the unit select a clearer channel by doing one of the following:

Press [↶] (Channel) if talking using [↶], or press [SP-PHONE] (Channel) if talking using [SP-PHONE].

OR

Walk closer to the base unit.

2-B Answering Calls

When a call is received, the unit rings and the Talk/Ringer and Ringer indicators on the handset and the IN USE indicator on the base unit flash rapidly.

If the handset is off the base unit, press [↶] or [SP-PHONE].

- You can also answer a call by pressing any button except [▼], [▲] and [OFF].

OR

If the handset is on the base unit, just lift up.

Selecting the ringer volume

Make sure the unit is not being used and the handset is lifted off the base unit.

- To select HIGH (preset), MEDIUM or LOW, press [▼] or [▲] to check the current volume, then press [▲] or [▼] within 10 seconds to select the volume. The volume will change and ring.
- To turn the ringer OFF, press and hold [▼] until 2 beeps sound.
- To turn the ringer ON, press [▼] or [▲].
The ringer will sound at the LOW level.
- You can select the ringer volume while an external call is being received. Press [▼] or [▲] while the unit is just ringing.
To set to OFF, press and hold [▼] until 2 beeps sound.

Selecting the ringer tone

Make sure the unit is not being used and the handset is lifted off the base unit. 6 ringer tones are available.

Press [▼] or [▲], then press [1] (preset) to [6] within 10 seconds.

Lighted handset keypad

The handset dialing buttons will light when you press a button or lift the handset off the base unit. The light will go out after a few seconds.

3 Special Features

3-A Automatic Security Code Setting

Each time you place the handset on the base unit, the unit automatically selects one of a million security codes. These codes help prevent the unauthorized use of your telephone line by another cordless telephone user.

3-B Handset Locator

You can locate the handset or page the handset user with beep tones from the base unit.

- 1 Press **[HANDSET LOCATOR]** on the base unit.
 - The Talk/Ringer and Ringer indicators on the handset and the IN USE indicator on the base unit flash and the handset beeps for 1 minute.
- 2 To stop paging, press **[HANDSET LOCATOR]** again or press **[OFF]** on the handset.

3-C Temporary Tone Dialing (For Rotary or Pulse Service Users)

Press **[*]** (TONE) before entering access numbers which require tone dialing.

- The dialing mode changes to tone. You can enter numbers to access an answering service, electronic banking service, etc. When you hang up, the mode will return to pulse.

3-D For Call Waiting Service Users

Press **[FLASH/CALL WAIT]** if you hear a call-waiting tone while talking.

- The first call is put on hold and you can answer the second call.
- To return to the first caller, press **[FLASH/CALL WAIT]** again.
- Call waiting service cannot be used when a parallel connected telephone is in use.
- If this function does not operate properly, consult your telephone company for details.

4 Things You Should Know

4-A Battery

Recharge

When the RECHARGE indicator flashes or the unit beeps intermittently, place the handset on the base unit for about 6 hours to recharge the battery.

- If you DO NOT recharge the handset battery for more than 15 minutes, the RECHARGE indicator will continue to flash.

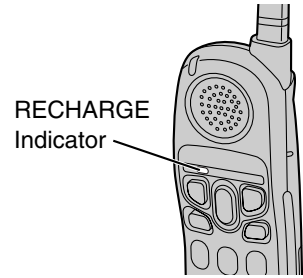

Battery replacement:

If you cleaned the charge contacts and fully charged the battery, but after a few telephone calls, the RECHARGE indicator flashes, the battery needs to be replaced. Please order a new Panasonic HHR-P513 (N4HHEPA00001) battery at the telephone number shown on section 1-A. To replace the battery, see section 1-C, step 2.

A nickel metal hydride battery that is recyclable powers the product you have purchased. Please call 1-800-8-BATTERY for information on how to recycle this battery.



Battery information

After your Panasonic battery is fully charged:

Operation	Operating time
While in use (TALK)	Up to about 5 hours
While not in use (Standby)	Up to about 11 days

- The battery operating time may vary depending on usage conditions and ambient temperature.
- Clean the charge contacts of the handset and the base unit with a soft, dry cloth once a month. Clean more often if the unit is subject to grease, dust or high humidity.** Otherwise the battery may not charge properly.
- If the battery is fully charged, you do not have to place the handset on the base unit until the RECHARGE indicator flashes. This will maximize the battery life.
- The battery cannot be overcharged.

4-B Belt Clip

You can hang the handset on your belt or pocket using the included belt clip.

To attach the belt clip

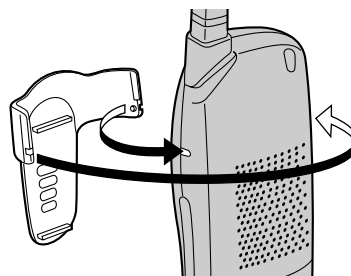

To remove the belt clip

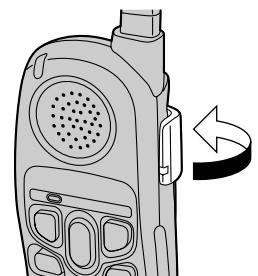



4-C Shoulder Rest Attachment

Use the shoulder rest attachment if you need to keep your hands free during a phone conversation.

To attach the shoulder rest attachment

Attach the included belt clip to the handset (4-B), then attach the shoulder rest attachment to the belt clip as shown below. You will hear a click when the shoulder rest attachment is in place.

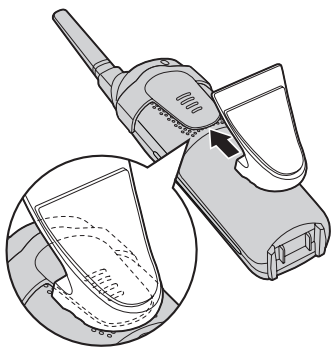

To remove the shoulder rest attachment

Slide the base of the attachment in the direction of the arrow as shown below.

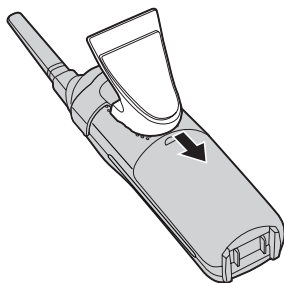

4-D Optional Headset

Connecting an optional headset to the handset allows hands-free phone conversation. Use only a Panasonic KX-TCA60, KX-TCA86, KX-TCA88, KX-TCA91, KX-TCA92, or KX-TCA98 headset.

To order, call the accessories telephone number on section 1-A.

Connecting an optional headset to the handset

Open the headset jack cover, and insert the headset plug into the headset jack as shown below.

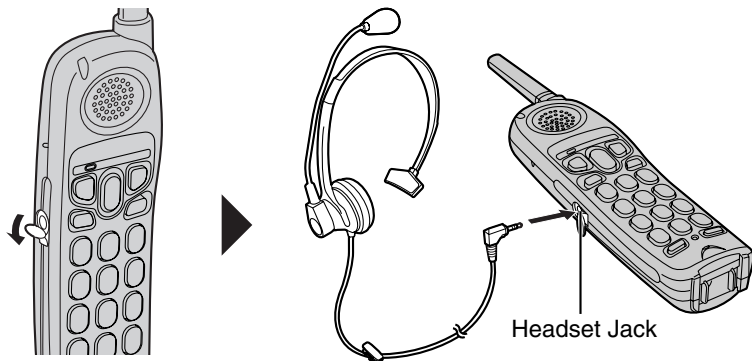

- Headset sold separately. Model shown here is KX-TCA88.

To switch to the speakerphone while using the headset:

Press [SP-PHONE]. To return to the headset, press [↶].

4 Things You Should Know



4-E Wall Mounting

This unit can be mounted on a wall phone plate.

- 1 Press the tabs in the direction of the arrows (①), then remove the wall mounting adaptor (②).

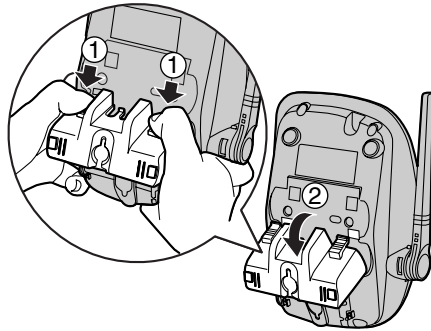

- 2 Connect the AC adaptor.
 - Fasten the AC adaptor cord to prevent it from being disconnected.

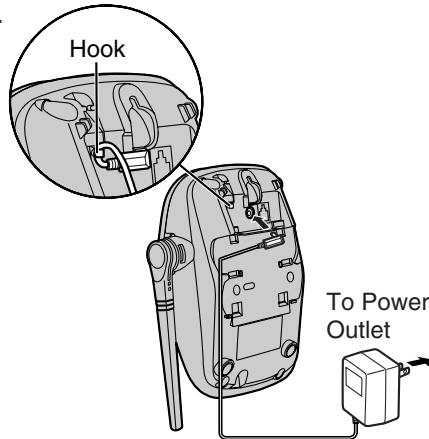

- 3 Tuck the telephone line cord inside the wall mounting adaptor, then push the adaptor in the direction of the arrows (① and ②).
 - The word "UP WALL" should face upward.

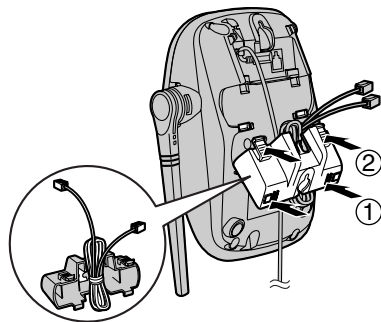

- 4 Connect the telephone line cord. Mount the unit, then slide down.
 - Raise the antenna.

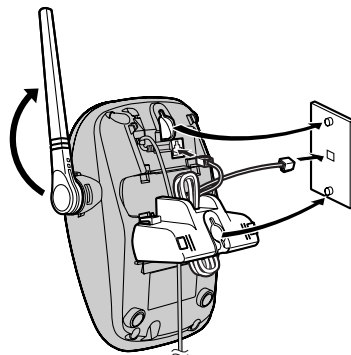

- 5 **To charge the handset battery:** Place the handset on the base unit.
 - The CHARGE indicator lights and the unit beeps once.

4-F Base Unit Location/Noise

Calls are transmitted between the base unit and the handset using wireless radio waves. **For maximum distance and noise-free operation**, the recommended base unit location is:

Away from electrical appliances such as a TV, personal computer or another cordless phone.

In a HIGH and CENTRAL location with no obstructions such as walls.

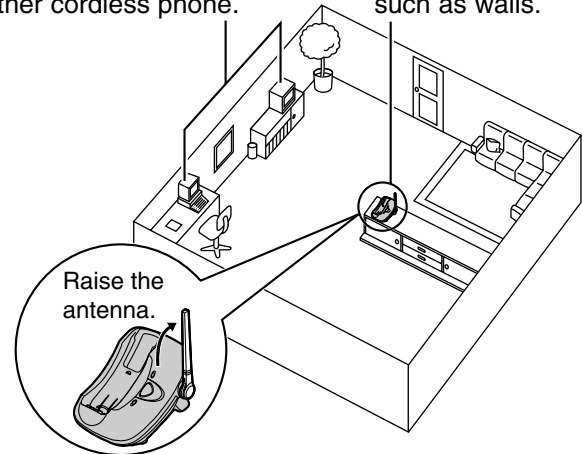

Note:

- If you use the handset near a microwave oven which is being used, noise may be heard from the receiver or the speaker. Move away from the microwave oven and closer to the base unit.
- If you use the handset near another cordless phone, noise may be heard. Move away from the other cordless phone and closer to your base unit.

4-G Specifications

■ Base unit

Power Supply:	AC Adaptor (120 V AC, 60 Hz)
Power Consumption:	Standby: Approx. 2.6 W Maximum: Approx. 3.9 W
Frequency:	2.402 GHz–2.480 GHz
Dimensions (H × W × D):	Approx. 104 mm × 148 mm × 173 mm (4 3/32" × 5 27/32" × 6 13/16")
Mass (Weight):	Approx. 310 g (0.68 lb.)

■ Handset

Power Supply:	Ni-MH battery (2.4 V, 1,500 mAh)
Frequency:	2.402 GHz–2.480 GHz
Dimensions (H × W × D):	Approx. 246 mm × 52 mm × 41 mm (9 11/16" × 2 1/16" × 1 5/8")
Mass (Weight):	Approx. 210 g (0.46 lb.)
Security Codes:	1,000,000

■ Dialing Mode:

Tone (DTMF)/Pulse

■ Operating Environment:

5°C–40°C

Specifications are subject to change without notice.

Energy Star:

- As an ENERGY STAR® Partner, Panasonic has determined that this product meets the ENERGY STAR guidelines for energy efficiency. ENERGY STAR is a U.S. registered mark.



4-H Troubleshooting

Problem	Cause & Remedy
The unit does not work.	<ul style="list-style-type: none"> ● Check the settings (1-C). ● Charge the battery fully (4-A). ● Clean the charge contacts and charge again (4-A). ● Install the battery properly (1-C). ● Place the handset on the base unit and unplug the AC adaptor to reset it. Plug in, and try again. ● Re-install the battery (1-C) and charge it fully.
An alarm tone sounds when you press [] or [SP-PHONE].	<ul style="list-style-type: none"> ● You are too far from the base unit. Walk closer and try again. ● Place the handset on the base unit and try again. ● Plug in the AC adaptor. ● Raise the base unit antenna.
Static, sound cuts in/out, fades. Interference from other electrical units.	<ul style="list-style-type: none"> ● Move the handset and the base unit away from other electrical appliances (4-F). ● Walk closer to the base unit. ● Raise the base unit antenna. ● Select a clearer channel (2-A).
The handset does not ring.	<ul style="list-style-type: none"> ● The ringer volume is set to OFF. Set to HIGH, MEDIUM or LOW (2-B).
Previously programmed information is erased.	<ul style="list-style-type: none"> ● If a power failure occurs, programmed information may be erased. Reprogram if necessary.

Problem	Cause & Remedy
You cannot redial.	<ul style="list-style-type: none"> ● If the last number dialed was more than 32 digits long, the number will not be redialed correctly.
You cannot page the handset.	<ul style="list-style-type: none"> ● The handset is too far from the base unit or is engaged in an outside call. Try again later.
The RECHARGE indicator flashes or the unit beeps intermittently.	<ul style="list-style-type: none"> ● Charge the battery fully (4-A).
You charged the battery fully, but the RECHARGE indicator continues to flash.	<ul style="list-style-type: none"> ● Clean the charge contacts and charge again (4-A). ● Install a new battery (1-C).
The CHARGE indicator light does not go out after the battery has been charged.	<ul style="list-style-type: none"> ● This is normal.
You cannot have a conversation using the headset.	<ul style="list-style-type: none"> ● Make sure the optional headset is connected properly (4-D). ● [SP-PHONE] may have been pressed. Press [] to switch to the headset.
If you cannot solve your problem	<ul style="list-style-type: none"> ● Call our customer call center at 1-800-211-PANA(7262). ● Panasonic's e-mail address for customer inquiries: consumerproducts@panasonic.com for customers in the USA or Puerto Rico ONLY

4-I Helpful Information

- **Environment**—do not place the unit in a room where the temperature is less than 5°C (41°F) or greater than 40°C (104°F). Allow 10 cm (4") clearance around the unit for proper ventilation. Avoid excessive smoke, dust, mechanical vibration, shock, or direct sunlight.
- **Medical**—consult the manufacturer of any personal medical devices, such as pacemakers, to determine if they are adequately shielded from external RF (radio frequency) energy. (The unit operates in the frequency range of 2402MHz to 2480MHz, and the power output level can range 0.01 watts.) Do not use the unit in health care facilities if any regulations posted in the area instruct you not to do so. Hospitals or health care facilities may be using equipment that could be sensitive to external RF (radio frequency) energy.
- **Routine care**—wipe the unit with a soft cloth. Do not use benzine, thinner, or any abrasive powder. When you leave the unit unused for a long period of time, unplug the AC adaptor from the outlet.

- **If there is any trouble**—disconnect the unit from the telephone line and connect a known working phone. If the known working phone operates properly, have your unit repaired by one of the authorized Panasonic Factory Service Centers. If the known working phone does not operate properly, consult your telephone company.

- This cordless telephone is designed for use in the United States of America. Sale or use of this product in other countries may violate local laws.
- Ce téléphone sans fil est conçu pour être utilisé aux États-Unis d'Amérique. La vente ou l'emploi de cet appareil dans certains autres pays peut constituer une infraction à la législation locale.
- Este teléfono sin cordón fue elaborado para uso en los Estados Unidos de América. La venta o el empleo de este producto en ciertos países puede constituir violación de la legislación local.
- このコードレス電話機は、日本国外での使用を目的として設計されており、日本国内での使用は法律違反となります。従って、当社では日本国内においては原則として修理などのサービスは致しかねます。

5-A Preparación

1 Conecte como se muestra.

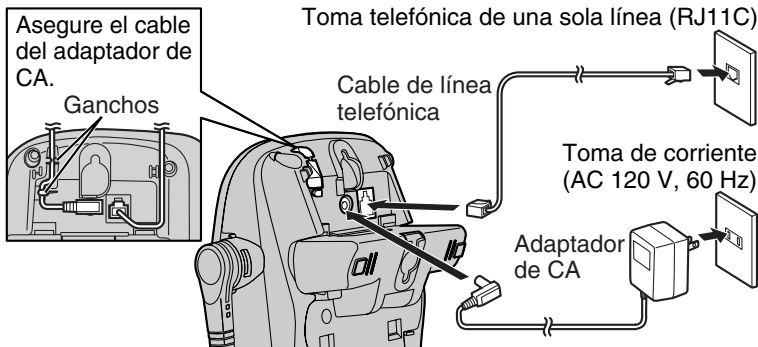

Para obtener el máximo alcance y un funcionamiento sin ruidos, ponga la unidad base en un lugar ELEVADO y CÉNTRICO sin obstrucciones ni interferencias de aparatos eléctricos.

• El adaptador de CA debe permanecer conectado en todo momento.

2 Inserte la batería (①), y presionela hacia abajo hasta que se acomode en el compartimiento (②). Cierre la cubierta.

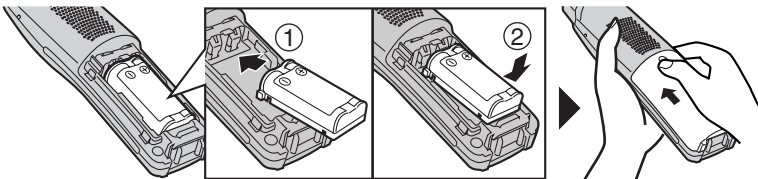

3 Cargue la batería durante unas 6 horas.

• El indicador CHARGE se encenderá y suena un pitido.

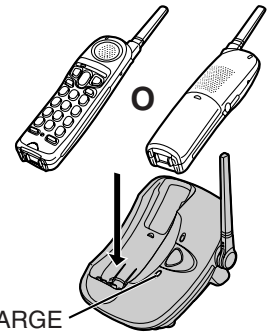

Para seleccionar el modo de marcación por TONO (preajustado) o PULSACIÓN

Utilizando la unidad portátil cerca de la unidad base usted puede programar el modo de marcación. **Asegúrese de que la unidad no se está usando y de que la unidad portátil se ha levantado de la unidad base antes de la programación.**

Mientras presiona [FLASH/CALL WAIT]:

Mantenga presionado [#] (PULSACIÓN) hasta que la unidad emita pitidos.

○

Mantenga presionado [*] (TONO) hasta que la unidad emita pitidos.

• Si suenan 3 pitidos durante la programación, acérquese más a la unidad base y comience de nuevo desde el principio.

5-B Funcionamiento

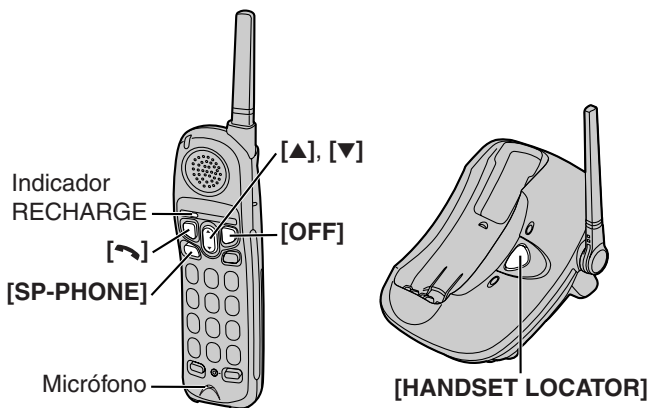

• Cuando el indicador RECHARGE parpadee o la unidad emita pitidos intermitentemente, cargue la batería.

Para hacer llamadas

1. Presione [↶] y luego marque el número de teléfono.

○

Para tener una conversación con las manos libres, presione [SP-PHONE] y marque el número de teléfono. Cuando la otra persona conteste, hable dirigiéndose hacia el micrófono.

2. Para colgar, presione [OFF] o ponga la unidad portátil en la unidad base.

• Si interfiere ruido en su conversación, presione [↶] (Canal) si conversa utilizando [↶] o presione [SP-PHONE] (Canal) si conversa utilizando [SP-PHONE], o acérquese más a la unidad base.

Para contestar llamadas

Si la unidad portátil no está en la unidad base, presione [↶], [SP-PHONE] o cualquier tecla excepto [▼], [▲] y [OFF].

○

Si está en la unidad base, levántela solamente.

Para seleccionar el volumen del timbre

Asegúrese de que la unidad no se está usando y de que la unidad portátil se ha levantado de la unidad base.

• **Para seleccionar ALTO (preajustado), MEDIO o BAJO**, presione [▼] o [▲] para checar el volumen actual, y luego presione [▲] o [▼] antes de que pasen 10 segundos para seleccionar el volumen. El volumen cambiará y sonará.

• **Para apagar el timbre**, mantenga presionado [▼] hasta que suenen 2 pitidos.

• **Para encender el timbre**, presione [▼] o [▲]. El timbre sonará en un nivel BAJO.

Localización de la unidad portátil

Presione [HANDSET LOCATOR] en la unidad base.

• La unidad portátil emite pitidos durante 1 minuto.

• Para detener la localización, presione de nuevo [HANDSET LOCATOR] o presione [OFF] en la unidad portátil.