

4-D Batería

Carga de la batería

Ponga la unidad portátil en el cargador y cárguela durante **12 horas aproximadamente** antes de utilizarla por primera vez.

Durante la carga de la batería, el icono de batería se mostrará como abajo.



- Cargue la batería cuando:
 - se visualice "LOW BATTERY", o
 - " " parpadee en la pantalla.

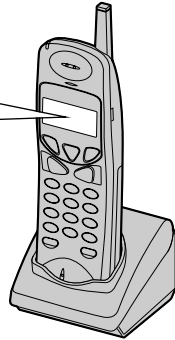

Información acerca de la batería

Después de que su batería Panasonic esté completamente cargada:

Operación	Duración aproximada de la batería
Mientras se utiliza (HABLAR)	Hasta 10 horas*
Mientras no se utiliza (Espera)	Hasta 5.5 días

- *En caso de que el modo Range Extender esté puesto en "OFF", consulte la página 48 de las instrucciones de funcionamiento en inglés.
- La vida de la batería podrá acortarse dependiendo de las condiciones de uso y temperatura ambiental.
- Limpie los contactos de carga de la unidad portátil y del cargador con un paño blando y seco una vez al mes. Limpie más a menudo si la unidad está expuesta a la grasa, polvo o humedad alta. De lo contrario, la batería tal vez no se cargue correctamente.
- La batería no se puede sobrecargar.

4-H Sustitución de la batería

Si se visualiza "LOW BATTERY" y/o parpadea " " después de haberla cargado completamente, sustituya la batería con una nueva Panasonic PQWBTG1000N. Para hacer el pedido, llame al número de teléfono para accesorios de la sección 1-A.

- 1 Quite la tapa deslizándola mientras presiona la flecha.

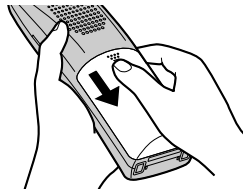

- 2 Sustituya la batería de la unidad portátil con los contactos de carga hacia abajo.

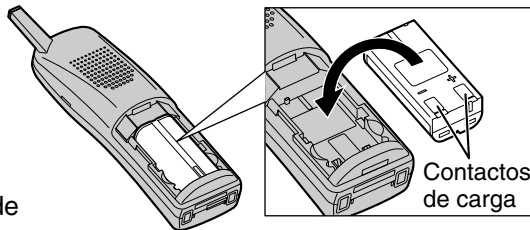

- 3 Cierre la tapa. Asegúrese de cargar la nueva batería durante 12 horas.

3-D Instalación en pared

El cargador puede instalarse en una pared. Instale los tornillos utilizando la plantilla de abajo. Instale el cargador y luego deslícelo hacia abajo.

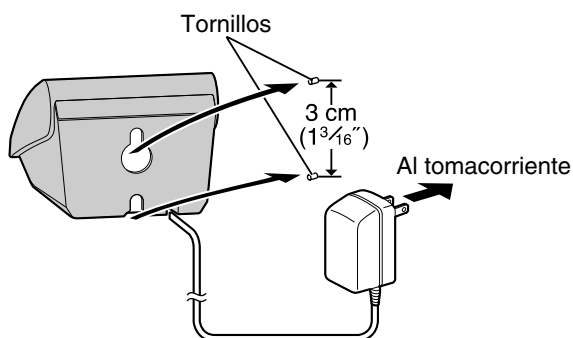

Plantilla de pared

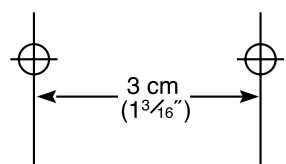

Panasonic

2.4GHz Cordless Handset
Model No. **KX-TGA100N**

Installation Manual



PLEASE READ BEFORE USE AND SAVE.

Charge the battery for about 12 hours before initial use.

Contents by Section

- 1 Getting Started
- 2 Registration
- 3 Things You Should Know
- 4 Referencia rápida

KX-TGA100N is the optional cordless handset for the KX-TG1000N/ KX-TG1050N. The installation manual only describes the steps necessary to start up the handset. Please read the KX-TG1000N/KX-TG1050N operating instructions for further details.

Panasonic World Wide Web address: <http://www.panasonic.com> for customers in the USA or Puerto Rico

Panasonic Consumer Electronics Company,
Division of Matsushita Electric Corporation of America
One Panasonic Way, Secaucus, New Jersey 07094

Panasonic Sales Company,
Division of Matsushita Electric of Puerto Rico, Inc.
Ave. 65 de Infantería, Km. 9.5, San Gabriel Industrial Park
Carolina, Puerto Rico 00985

Panasonic's e-mail address for customer inquiries:
consumerproducts@panasonic.com

1 Getting Started



1-A Accessories

- Charger unit1
Order No. PQWETGA100N

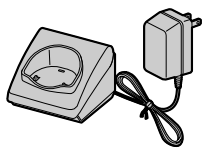

- Battery1
Order No. PQWBTG1000N

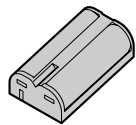

- Belt Clip1
Order No. PQZHTG1000N



- Handset Cover1
Order No. PQYNTG1000N



• For extra orders, call 1-800-332-5368.

1-B Location of Controls

Handset

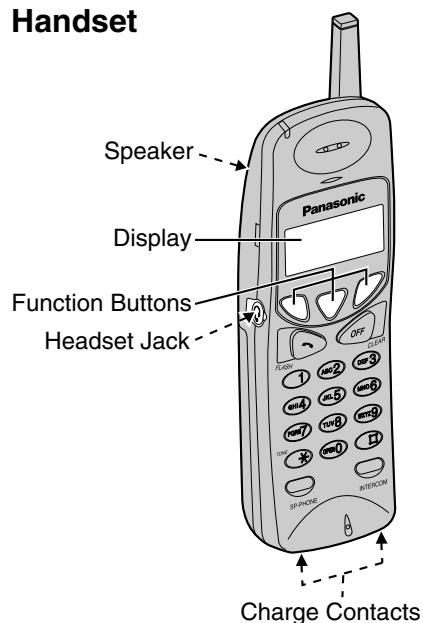

Charger unit

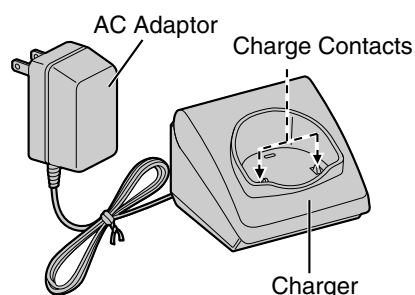

1-C Settings

1 Connect the charger unit as shown.

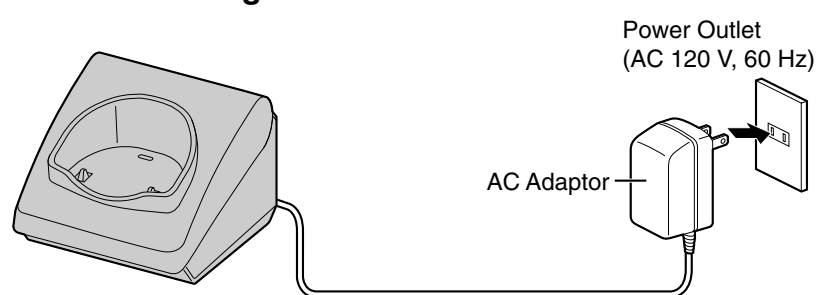

- The AC adaptor must remain connected at all times. (It is normal for the adaptor to feel warm during use.)

2 Install the battery in the handset.

Install the battery in the handset with the charge contacts facing down and close the handset cover, locking it into place.

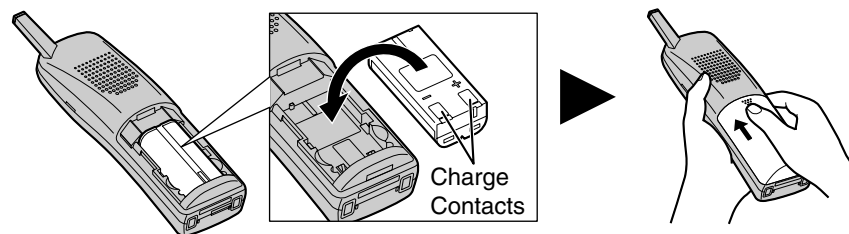

3 Things You Should Know



3-A Belt Clip

You can hang the handset on your belt or pocket using the belt clip.

To attach the belt clip

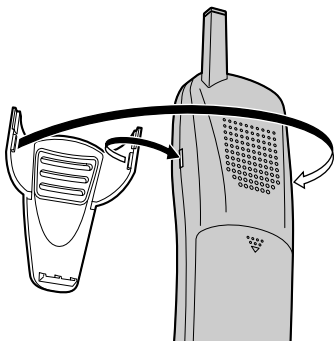

To remove the belt clip



3-B Optional Headset

Plugging an optional headset into the handset allows a hands-free phone conversation. Please use only the Panasonic KX-TCA88 headset. To order, call the accessories telephone number in section 1-A.

Connecting the optional headset to the handset

Open the headset jack cover, and connect the optional headset to the headset jack as shown.

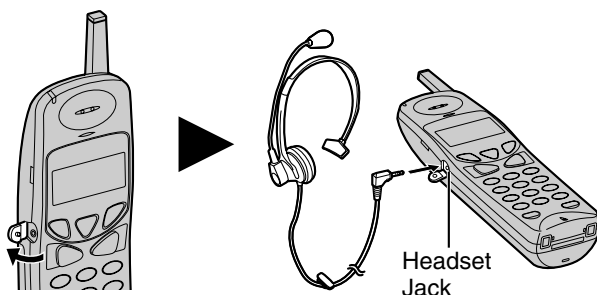

When the optional headset is connected to the handset, make sure to use the headset to talk with the caller. If you want to have a normal cordless phone conversation, disconnect the headset.

3-C Battery Replacement

If "LOW BATTERY" is displayed and/or " " flashes after being fully charged, replace the battery with a new Panasonic PQWBTG1000N battery. To order, call the accessories telephone number in section 1-A.

1 Remove the cover by sliding while pressing the arrow.

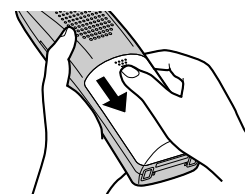

2 Replace the battery in the handset with the charge contacts facing down.

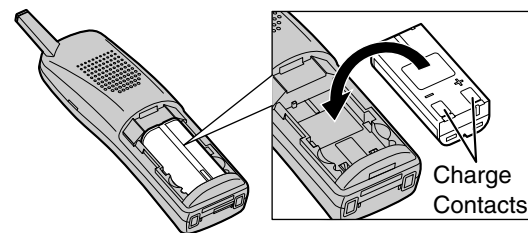

3 Close the cover. Make sure to charge the new battery for 12 hours.

3-D Wall Mounting

The charger can be wall mounted. Install screws using the wall template below. Mount the charger, then slide it down.

Wall Template

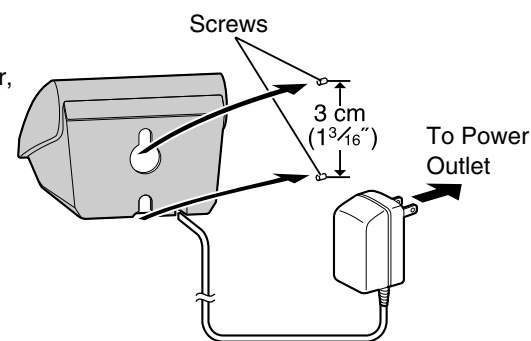
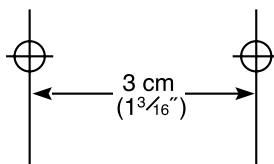



1-D Battery

Charging the battery

Place the handset on the charger and charge for **about 12 hours** before initial use.

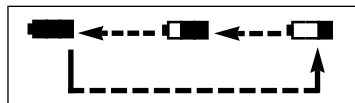
During charging the battery, the battery icon cycles as shown below.



- Recharge the battery when:
 - “LOW BATTERY” is displayed, or
 - “” flashes on the display.

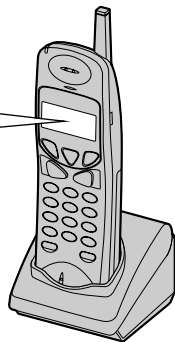

Battery information

After your Panasonic battery is fully charged:

Operation	Approx. battery life
While in use (TALK)	Up to 10 hours*
While not in use (Standby)	Up to 5.5 days

*In case the Range Extender Mode is set to “OFF”, see page 48 in the English operating instructions.

- Battery life may be shortened depending on usage conditions and ambient temperature.
- Clean the charge contacts of the handset and the charger with a soft, dry cloth once a month. Clean more often if the unit is subject to grease, dust or high humidity.** Otherwise the battery may not charge properly.
- The battery cannot be overcharged.

2 Registration

Registration is necessary for cordless handsets. An handset will be assigned the number at registration. The number is used as the handset number. You can register up to 4 handsets at the KX-TG1000N base unit.

Make sure the unit is in the standby mode initially.

- 1 After charging the handset, the display will show the following.

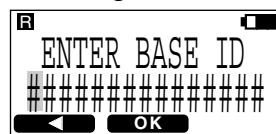

- 2 Enter the 15-digit Base Unit ID code located on the bottom of the base unit.

- If you misdial, press . Digits are erased from the right.

- 3 Press .

- A beep sounds and “PLEASE WAIT!!” is displayed.



- 4 Wait until a beep sounds on the handset and base unit.



- After a few seconds, the handset number (1 to 4) will be displayed.



- If “BASE BUSY TRY LATER” is displayed in step 4, the unit is in use. Wait until the unit is in the standby mode, and repeat steps from 2.
- If “ENTER BASE ID” is displayed in step 3, you entered a wrong Base ID code. Enter the correct code.

Things You Should Know

3-E Helpful Information

CAUTION:

To reduce the risk of fire or injury to persons, read and follow these instructions.

1. Use only the battery(ies) specified.
2. Do not dispose of the battery(ies) in a fire. They may explode. Check with local waste management codes for special disposal instructions.
3. Do not open or mutilate the battery(ies). Released electrolyte is corrosive and may cause burns or injury to the eyes or skin. The electrolyte may be toxic if swallowed.
4. Exercise care in handling batteries in order not to short the battery to conductive materials such as rings, bracelets, and keys. The battery and/or conductor may overheat and cause burns.
5. Charge the battery(ies) provided with or identified for use with this product only in accordance with the instructions and limitations specified in this manual.

WARNING:

TO PREVENT FIRE OR SHOCK HAZARD, DO NOT EXPOSE THIS PRODUCT TO RAIN OR ANY TYPE OF MOISTURE.

FCC and Other Information

When programming emergency numbers and/or making test calls to emergency numbers:

1. Remain on the line and briefly explain to the dispatcher the reason for the call before hanging up.
2. Perform such activities in the off-peak hours, such as early morning hours or late evenings.

This device complies with Part 15 of the FCC Rules. Operation is subject to the following two conditions: (1) This device may not cause harmful interference, and (2) this device must accept any interference received, including interference that may cause undesired operation.

Privacy of communications may not be ensured when using this phone.

CAUTION:

Any changes or modifications not expressly approved by the party responsible for compliance could void the user's authority to operate this device.

Note:

This equipment has been tested and found to comply with the limits for a Class B digital device, pursuant to Part 15 of the FCC Rules. These limits are designed to provide reasonable protection against harmful interference in a residential installation. This equipment generates, uses, and can radiate radio frequency energy and, if not installed and used in accordance with the instructions, may cause harmful interference to radio communications. However, there is no guarantee that interference will not occur in a particular installation. If this equipment does cause harmful interference to radio or television reception, which can be determined by turning the equipment off and on, the user is encouraged to try to correct the interference by one or more of the following measures:

- Reorient or relocate the receiving antenna.
- Increase the separation between the equipment and receiver.
- Connect the equipment into an outlet on a circuit different from that to which the receiver is connected.
- Consult the dealer or an experienced radio/TV technician for help.

Some cordless telephones operate at frequencies that may cause interference to nearby TVs and VCRs. To minimize or prevent such interference, the base of the cordless telephone should not be placed near or on top of a TV or VCR. If interference is experienced, move the cordless telephone further away from the TV or VCR. This will often reduce, or eliminate, interference.

Operating near 2.4GHz electrical appliances may cause interference. Move away from the electrical appliances.

CAUTION:

To comply with FCC RF exposure requirements, the handset should be carried with the specific belt-clip provided for the handset to ensure compliance. Other non-tested belt-clips or similar body-worn accessories may not comply, therefore, should be avoided.

4 Referencia rápida



La KX-TGA100N es la unidad portátil inalámbrica opcional para la KX-TG1000N/KX-TG1050N. El manual de instalación solamente describe los pasos necesarios para iniciar la unidad portátil.

4-A Accesorios

- Cargador1
N.º de pedido PQWETGA1000

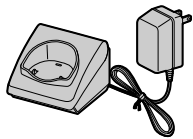

- Batería1
N.º de pedido PQWBTG1000N

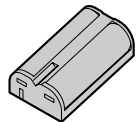

- Presilla para cinturón1
N.º de pedido PQZHTG1000N



- Cubierta de la unidad portátil ..1
N.º de pedido PQYNTG1000N



- Para solicitar accesorios extra, llame al 1-800-332-5368.

4-B Ubicación de los controles

Unidad portátil



Cargador

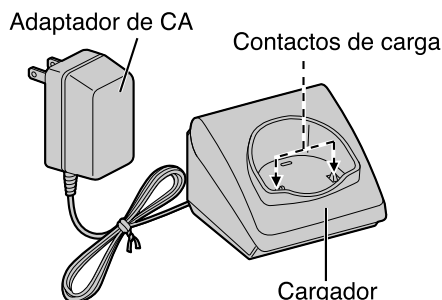

4-C Ajustes

1 Conecte la unidad de carga.

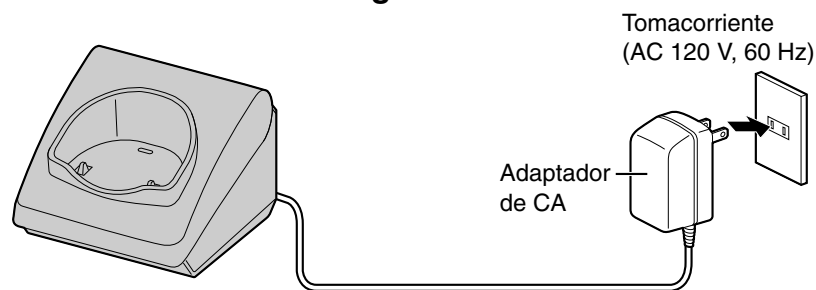

- El adaptador de CA deberá permanecer conectado en todo momento. (Durante la utilización es normal que se caliente el adaptador.)

2 Instale la batería en la unidad portátil.

Instale la batería en la unidad portátil con los contactos de carga hacia abajo y cierre la tapa de la unidad portátil, bloqueándola en su sitio.

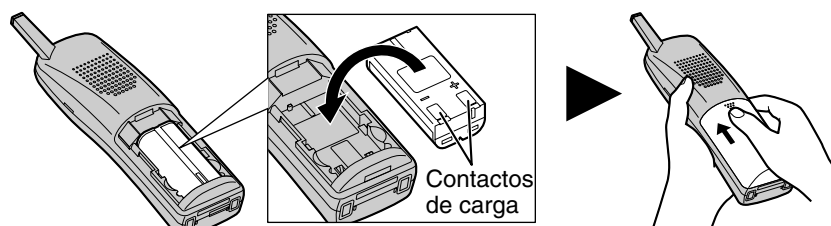

4-E Registro

El registro resulta necesario para las unidades portátiles. Al hacerse el registro se le asignará un número a la unidad portátil. El número de la unidad portátil se utiliza como número de extensión. Podrá registrar un máximo de 4 unidades portátiles en la unidad base del KX-TG1000N.

Asegúrese de que la unidad base esté en el modo de espera inicialmente.

- 1 Después de cargar la unidad portátil, se mostrará la visualización de la derecha.



- 2 Introduzca el código de identificación (ID) de 15-dígitos de la unidad base.

- Si se equivoca, pulse . Los dígitos serán borrados desde la derecha.

- 3 Presione .

- Sonará un pitido y se visualizará "PLEASE WAIT!!".

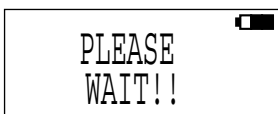

- 4 Espere hasta que suene un pitido en la unidad portátil y en la unidad base.



- Después de unos pocos segundos, se visualizará el número de la unidad portátil (1 a 4).



- Si se visualiza "BASE BUSY TRY LATER" en el paso 4, la unidad está siendo usada. Espere hasta que la unidad esté en el modo de espera, y repita los pasos desde el 2.
- Si se visualiza "ENTER BASE ID" en el paso 3, habrá introducido un número de código ID de unidad base incorrecto. Introduzca el código correcto.

4-F Presilla para el cinturón

Puede colgar la unidad portátil en su cinturón o bolsillo utilizando la presilla de cinturón.

Para fijar la presilla de cinturón

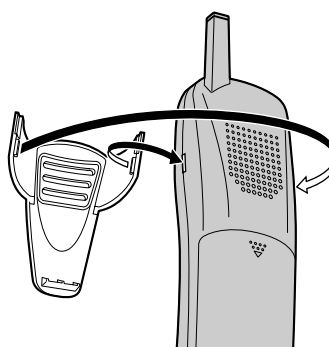

Para quitar la presilla de cinturón



4-G Auricular opcional

Conectando un auricular opcional a la unidad portátil se pueden realizar conversaciones telefónicas con las manos libres. Utilice solamente el auricular KX-TCA88 de Panasonic.

Para hacer el pedido, llame al número de teléfono para accesorios de la sección 1-A.

Conexión del auricular a la unidad portátil

Abra la cubierta de la toma del auricular y conecte el auricular a la toma del auricular como se muestra en la ilustración.

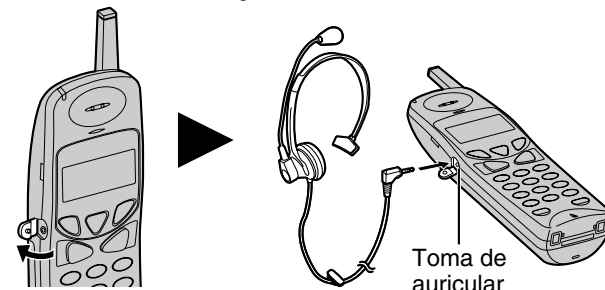

Cuando el auricular esté conectado, asegúrese de utilizarlo para conversar con la persona que llame. Desconéctelo si desea mantener una conversación telefónica normal con la unidad portátil.