



# Replace PSRCM

<b>Classification</b>	Campaign Bulletin	<b>Section/Group</b>	17 - Electrical	<b>Country/Region</b>	North America
<b>Year</b>	2014	<b>Model</b>	Model S	<b>Version</b>	All

**Bulletin Classification:** *This campaign bulletin addresses a known non-safety-related condition and provides recommended technical diagnosis and repair procedures. Apply this procedure to all vehicles in the affected VIN range listed. These instructions assume knowledge of motor vehicle and high voltage electricity repairs, and should only be executed by trained professionals. Tesla Motors assumes no liability for injury or property damage due to a failure to properly follow these instructions or repairs attempted by unqualified individuals.*

## Condition

A defective component within the Passive Safety Restraints Control Module (PSRCM) might lead to less-than-ideal electrical characteristics, which can cause error messages and airbag warning lamp illumination. The PSRCM is being replaced as part of an additional quality containment.

## Correction

Replace the PSRCM.

Required Part(s):	Part Number	Description	Quantity
	1005273-00-F	PSRCM UNIT ASSY, NA MARKET	1

These part numbers were current at the time of publication. Use the revisions listed or later, unless otherwise specified in the Parts Manual.

Correction Description	Correction	Time
Vehicle Inspection Only; PSRCM Replacement Not Required	S011417007	0.10
Replace PSRCM Due To A Defective Component	S021417007	0.45

## Procedure

1. Replace the PSRCM (refer to Service Manual procedure 17152202).

**NOTE:** In the “Part Serials” window in the Repair Order, enter the serial number of the new PSRCM in the “New Serial Number” field, and then enter the serial number of the replaced PSRCM in the “Comments” field (Figure 1).

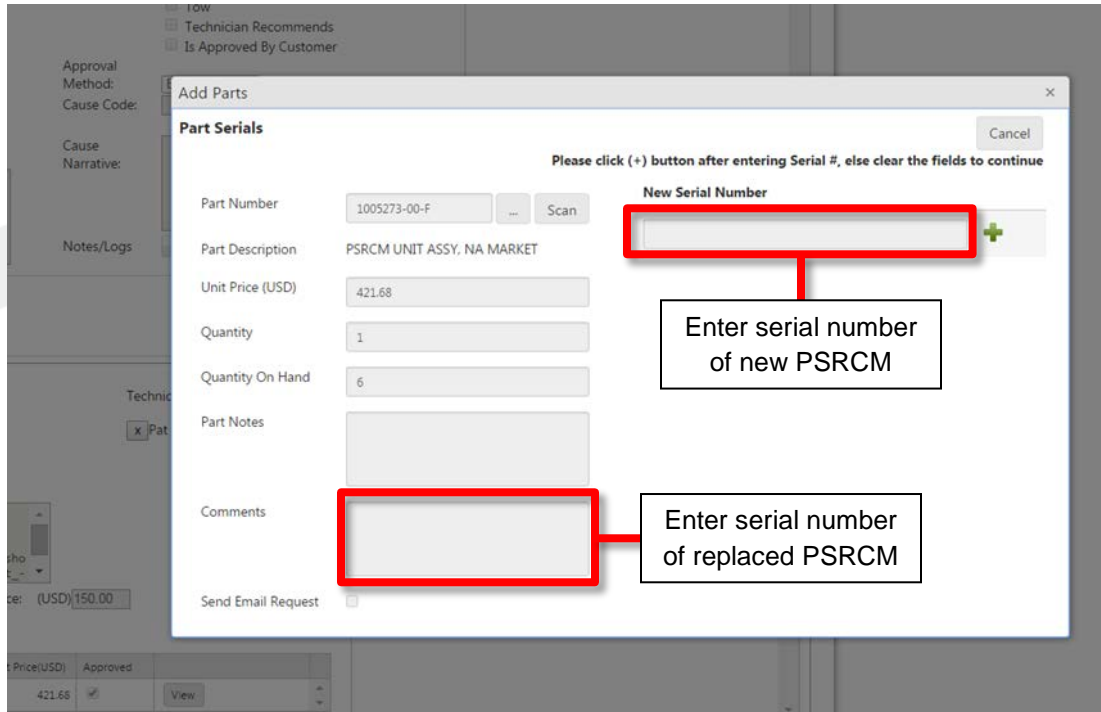

Figure 1

2. At the top of the label on the replaced PSRCM, cross out the part number and write “DO NOT USE” in red ink (Figure 2).



Figure 2

---

**Affected VIN(s)** Some Model S vehicles built between approximately November 10, 2014 and November 22, 2014.

**NOTE:** This is a simplified summary of the affected VIN list. Refer to the VIN/Bulletin Tracker or Customer/Vehicle profile to determine applicability of this bulletin for a particular vehicle.

For feedback on the accuracy of this document, email [ServiceBulletinFeedback@teslamotors.com](mailto:ServiceBulletinFeedback@teslamotors.com).

