

Index	
Aprons	46
Axle Vises	27
Bottom Bracket Tools	28-29
Brake Tools	33-34
Chain Tools	37
Cleaning & Lubrication	35-36
Cone Wrenches	27
Crankset Tools	30-31
Display Systems	45
Frame & Fork Tools	38-44
Freewheel / Cassette Tools	26
Headset Tools	32
Hex Wrenches	22-25
Multi-Tools	21
Park Tool Logo Items	46
Pedal Tools	30-32
Pin Spanners	28-29
Pumps	15
Repair Stands	3-7
Repair Stand Accessories	3-7
Repair Stand Clamps, Covers & Parts	8
Spoke Wrenches	12
Sprocket Removers / Chain Whips	26
Tire & Wheel Tools	11-14
Tool Kits	16-20
Torque Wrenches	43
Truing Stands	9-10
Warranty Information	1
Wheel Dishing Gauges	11

Welcome, and thank you for taking a look at our 2006 catalog, our biggest and best yet. This year's lineup includes a great number of upgrades and updates, and we're excited to introduce a record number of new products (27) as well. These changes and new products illustrate our continued commitment to building the best, and most complete tool line in the world. The bicycle industry changes fast! New parts and components, lighter materials, and more complicated mechanical needs demand new tools. Our mission is to stay ahead of the industry and to provide professional mechanics and enthusiasts from around the world with the right tools...the best tools.

Thank you for choosing Park Tool. We appreciate your loyalty and we promise to do our best to build you the best.

Eric Hawkins, President



The rest of the story...John 3:16

¹⁶For God so loved the world that He gave His only Son. Whoever puts his trust in God's Son will not be lost but will have life that lasts forever.

// **Park Tool Web Site**

Completely re-designed, www.parktool.com is considered by many mechanics to be one of the most useful sites in the bicycle industry.

The easy to navigate site features:

- Up to date specs and photos of our entire 2006 product line
- Exploded view drawings and part numbers for most Park Tool products
- Downloadable versions of this catalog in French, German and Spanish
- Over 100 detailed, printable instructions and photos for almost any bicycle maintenance task or repair
- A virtual tour of our factory in St. Paul, MN
- "Tool Locator" for helping select the right tool for the job.
- Dealer locator with special Park Tool School references and links.
- Recommended tool lists for mechanics of various levels of expertise.
- One on one technical support through e-mail



Park Tool Limited Lifetime Warranty

Park Tool Company backs its tools with a limited lifetime warranty. If a Park Tool product fails to perform its intended purpose, under normal usage, due to defects in material or workmanship, the tool will be repaired or replaced at our option. Tools that are worn from normal use, or damaged due to accident, abuse, neglect, or modification are not covered by the warranty. When possible, tools not covered under warranty will be repaired for a reasonable charge. This warranty does not cover consequential damage or cost of injury incurred by the user. The TW-3 and TW-4 Torque Wrenches are warranted for one year from date of purchase. Tools for warranty consideration should be returned to the point of purchase or to Park Tool Company.

// The Park Tool School

Repair clinics are a great way for bike shops to show their expertise, attract new customers, and help current customers keep their bikes running smoothly. The Park Tool School is a program and curriculum designed to make the planning and teaching of repair clinics easy. A skilled shop staff, a copy of the BBB-1TG Instructor's Guide, and a BBB-1 Big Blue Book of Bicycle Repair for each clinic participant are all it takes to get started. Bike shops offering the Park Tool School are posted on the Park Tool web site, where those interested can access a list of participating shops.

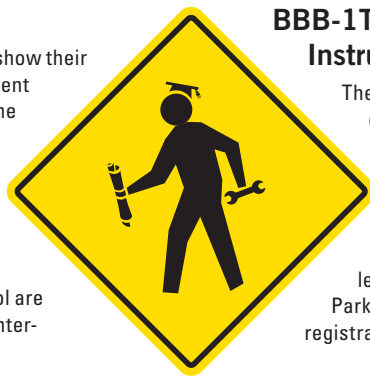

BBB-1TG //

Instructors Guide for The Big Blue Book of Bicycle Repair

The BBB-1TG Instructor's Guide is written by Calvin Jones, Park Tool's Director of Education Programs. Using his 30 years experience as a mechanic, educator, and writer, Calvin provides all the time-proven information a shop staff needs for a successful Park Tool School clinic. The first half of this indispensable guide covers all phases of planning, organizing, promoting, and teaching a clinic. The second half provides detailed, step-by-step repair procedures, which are supplemented by hundreds of photos, teaching tips, lecture notes, course outlines, and demonstration ideas. The BBB-1TG includes Park Tool School student participation certificates, promotional poster, sample registration forms, and more.

CHAPTER 7 / DERAILLEUR SYSTEMS

7-4, Figure 2

 Push gauge bracket toward hub before rotating arm. This prevents gauge from being forced against rim.
 Rotate DAG-1 and rim valve 180 degrees to the three o'clock position. Slide indicator toward rim to same point near valve. There are three possible results.
Condition A: The gauge barely touches the rim, or has a small gap less than 4mm. In this case the hanger is aligned horizontally.
Condition B: The pointer is away from the rim some distance. The hanger is misaligned (7-4, Figure 4). If the distance is greater than 4mm, the hanger will need re-alignment. Use a 4mm hex wrench to gauge the gap.
Condition C: The pointer strikes inside the rim, indicating a misaligned hanger (7-4, Figure 5). It is easiest to determine the error by seeing the gap between the rim and gauge. Re-set tool to rim contact at the 6:00 position and rotate back to the 3:00 position. There will be a gap between the rim and the gauge.
7-4, Figure 3

 Set DAG-1 to reference rim at the nine o'clock position.
 Loosen the sliding gauge knob and move the sliding gauge to contact the rim, then secure the knob.
7-4, Figure 4

 Gauge indicating misaligned hanger.
7-4, Figure 5

 Reset gauge if it falls inside rim.
7-4, Figure 6

 Use the frame to control bending of the hanger.
7-4, Figure 7

 Use a 4mm gauge to check the tolerance.
7-4, Figure 8

 Remove the tool and re-install the derailleur.
 Check settings on both limit screws and check index settings (Outline Item 7-4.3 Limit Screw Adjustment and 7-4.5 Index Adjustment).
 The threads of the derailleur hanger are commonly 10mm x 1mm. If the derailleur installs with difficulty, the threads of the hanger should be tapped. As a test of thread acceptability, fully tighten the derailleur. If the derailleur bolt does not strip, the hanger is usable. If the threads strip and fail, it is possible for a professional mechanic to install a mild thread, or a front repair system (7-6, Figure 8). These repairs work well when properly done and allow the bike to be used as normal.
7-7 Derailleur
 Both derailleurs, with use, as plastic develops at the top of a rear derailleur, too play. It may be the old derailleur to a derailleur when the chain has more than a 1/4-inch Chain travels over the teeth, causing wear. Worm not engage well with the chain. The pulley wheels usually cut.

124 Park Tool Big Blue Book of Bicycle Repair www.parktool.com **124**

BBB-1 // The Big Blue Book of Bicycle Repair: A Do-It-Yourself Bicycle Repair Guide from Park Tool

A new book on bike repair from the company that wrote the book on bike repair products. Calvin Jones, Education Director at Park Tool, provides easy-to-follow, step-by-step instructions for keeping any road or mountain bike running smoothly. From tire repair and derailleur adjustment to wheel truing and bottom bracket replacement, The Big Blue Book of Bike Repair provides both the novice and veteran mechanic with the information needed to perform nearly any repair. Special topics such as tool selection, bike cleaning, and on-the-trail repairs are also covered, and an appendix at the back of the book provides valuable reference materials. Up to date with the latest technology, The Big Blue Book of Bike Repair is packed with hundreds of photos, as well as repair tips garnered from the author's 30 years as an educator and mechanic.



// Explain this Pierre: Investment Casting. It's a commonly heard term, but what exactly is it?

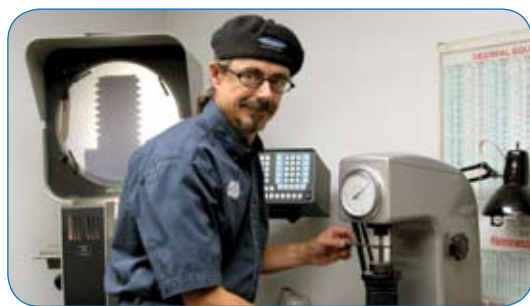

Park Tool's Head of Engineering Pierre Ostor

Investment Casting, also called Lost Wax Casting, is a great way to produce precise, highly detailed parts in medium sized quantities. Some common uses for this process are to make jewelry and golf club heads. A wide variety of materials can be used including: steel, titanium, aluminum, beryllium copper and stainless steel. The process of Investment Casting entails exactly what the name implies: an investment of material creating a mold. That mold then forms the part. The entire process takes somewhere between five and seven days.

In order, the investment casting sequence is as follows:

1. A wax replica of the desired part is produced using a machine similar to an injection molding press.

2. After injection, multiple wax replicas are attached to a sprue or tree to facilitate pouring.
3. The cluster of wax parts is then dipped or "invested" into ceramic slurry. The assembly is then coated with a fine ceramic sand and dried. This process is repeated several times to build shell thickness and strength.
4. The Cluster is the "flashed" by quickly heating shells until the wax drains. This produces a cavity duplicating the original wax part.
5. The ceramic shells are fired in a furnace at 1600-2000 degrees (F).(870-1093 C) to harden the mold.
6. Hot, molten material is pouring into the ceramic mold
7. After cooling the shell material is stripped away and the individual parts are separated from the sprue.
8. The parts are extremely hard so sometimes it is necessary to "soften" the parts to allow secondary operations such as machining or thread tapping.
9. Parts are re-heat treated to our precise specification, then plated or painted for use.

We use this process to produce a wide variety of parts. Most are complicated pieces with tight tolerances and high visibility. A few of the tools we utilize the investment casting process are: CT-5 Chain Tool, HW-2 Headset Wrench, HHP-2 Cup Press, MT-1 Multi Tool, CT-6 Chain Tool, as well as various clamp and truing stand small parts.



// Intro to Repair Stands

Investing in a high quality repair stand is the first step toward building a high quality workstation. Over the past 40 years we've built hundreds of thousands of repair stands for home mechanics, shop mechanics, and professional race mechanics all over the world. Many of the PRS-1 stands we built in the 1960's are still in use daily, and we're constantly striving to improve and update our newest generation of stands. Each of our models offer different features and benefits to ensure a model

for nearly every purpose. All of our stands are made to allow full rotation to ensure a comfortable working position at all times. We also offer a complete line of replacement parts to keep your investment running smoothly. Ask any professional mechanic about their stand and you're bound to hear "Park Tool" as the response. Insist on the quality and innovation of genuine Park Tool repair stands. Designed and built to last for years of use.

PRS-15 // Professional Race Stand

The PRS-15 is designed to be the finest folding repair stand made. Manufactured from the best materials to provide years of reliable service, the PRS-15 is lightweight, portable, and fully adjustable. The PRS-15 works with any bike and can be quickly turned into a complete mobile workstation by adding the optional Truing Stand, Bucket/Tool Kilt, and Paper Towel Holder accessories. Ideal for anyone wanting a premium quality repair stand that can be used in the workshop or packed and used at a race or event.

- Five-point leg system adjusts to create a super stable base on smooth or rough surfaces
- Shop quality 100-15X Extreme Range Clamp quickly adjusts
- Clamping height quickly adjusts from 40" to 60" (102cm to 152cm)
- Oversized aluminum upright tube is elliptically-shaped and heat-treated to resist flexing
- Quickly folds to 44" (112cm) for portability and storage
- Replaceable jaw covers (part #1259)
- Weighs just 22 lbs to fit tubes from 7/8" to 3" (24mm to 76mm)
- Fully adjustable clamping pressure prevents damage to thin-walled tubes
- Clamp rotates 360 degrees for easy access to any part of bike
- Narrow jaws allow clamping in tight access areas



Clamping height quickly adjusts from 44 to 60 inches 102cm to 152cm



BAG-15 // Travel & Storage Bag

Heavyweight nylon bag with shoulder strap for transporting and storing the PRS-15 Race Stand.

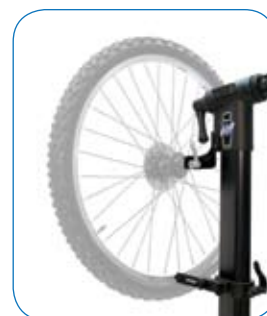

TS-15 // Truing Stand Attachment

The TS-15 attaches onto the PRS-15 Professional Race Stand for accurate truing of wheels up to 29". Simple, lightweight, and compact. Wheel dishing (centering) is performed by simply flipping the wheel in the TS-15.



PRS-15AP // Accessory Pack for PRS-15*

Turns the PRS-15 into a complete professional workstation. Includes BTK-1 Bucket and Tool Kilt, TS-15 Truing Stand, PTH-1 Paper Towel Holder, and BAG-15 Travel and Storage Bag.



PTH-1 // Paper Towel Holder

Paper towels are always handy for cleaning hands and parts. Keep them within reach with the PTH-1. Fits into the Receiver Ports of any PRS-15, PCS-10 and PCS-11 to hold a standard roll of paper towels. Also works great for hanging clothing, wheels, tires, etc.

BTK-1 // Bucket and Tool Kilt*

The innovative BTK-1 is a bucket mounted tool organizing system designed to fit into the Receiver Ports of any PRS-15, PCS-10 and PCS-11. The Tool Kilt's 40 assorted pockets keep tools organized and within easy reach, while the bucket can be used to store supplies or filled with water for cleaning. The bucket lid serves as a handy parts tray. When the repairs are completed, the Tool Kilt, tools, and accessories can be stowed and transported in the bucket. Just pick up the handle and go! The Tool Kilt is made from heavy nylon, with reinforced stitching for extra strength. The specially sized 5.3 gallon bucket is built from super strong high-density polyethylene for years of service.



* Tools not included

// Folding Repair Stands

Each of these three Folding Stands is designed to fold small, adjust in height and clamp a huge variety of tubing and tubing sizes. The unique three-point leg system creates an extremely solid base capable of handling nearly any bike.

- Height adjusts from 39" to 57" (99cm to 145cm)
- Clamps adjust to fit tubes from 7/8" to 3" (24mm to 76mm) and utilizes a narrow 3 1/2" (89cm) clamping surface to fit into tight places
- Replaceable jaw covers (#1185K)
- Clamp rotates 360 degrees for easy access to any part of the bike
- Adjustable clamp pressure prevents damage to thin walled tubes
- Folds to 41" (104cm) in length for portability and storage



PCS-10 // Home Mechanic Repair Stand

Built with a few upgrades from the PCS-9 to make set up, take down and use, quicker and easier.

- Quick adjust, cam-type clamp allows single action clamping
- Quick release height adjustment
- Quick release and locking sliding yoke for fast folding and extra stability
- World famous composite top tube for smooth rotation and solid locking
- Sliding retention rings to lock folding legs in place
- Exclusive Receiver Pod accessory system integrated into the top tube and height adjustment collar to allow easy installation of PRS-15 accessories.

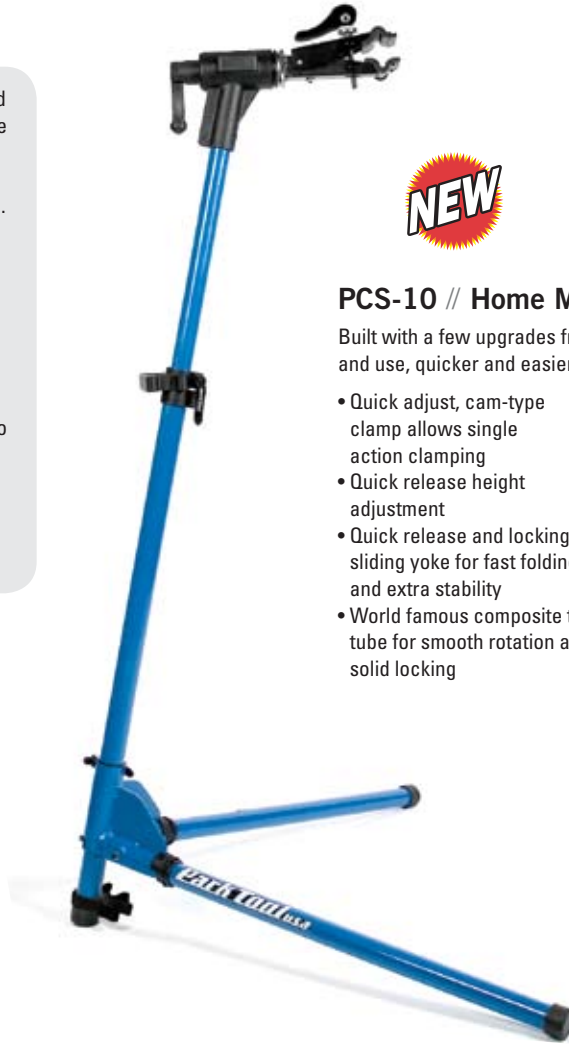

PCS-11 // Super Lite Repair Stand

Same great features as the PCS-10 yet 35% lighter. Nicely upgraded with an aluminum clamp body and extruded aluminum structural tubing. The PCS-11 weighs a scant 14 lbs (6.4kg) for the ultimate in lightweight portability. The PCS-11 is sure to be a favorite of race teams and on-the-go mechanics worldwide.



PCS-10/11 Folded

PCS-9 // Home Mechanic Repair Stand

Park Tool quality in an entry-level stand.





PRS-20 // Team Race Stand

The PRS-20 Team Race Stand is a compact, Euro-style work stand that securely holds the bike without clamping the frame tubes or seat post. Ideal for bikes with ultra lightweight frame tubes and seatposts, and for bikes with tight access areas that can't be clamped. Originally designed for the mechanics of the Tour de France-winning US Postal Service Pro Cycling Team, the PRS-20 is now available to professional and home mechanics everywhere.

- Quick release mounts hold bike securely by the front or rear dropouts
- Vinyl-covered cradle and quick release retention strap stabilize bottom bracket
- 360 degree horizontal rotation allows easy access to both sides of bike
- Folds to 33" (84cm) for easy transport and storage
- Stable tripod base
- Built-in "sleeping hub" allows easy chain cleaning with rear wheel removed
- Bottom bracket height quickly adjusts from 28" to 38" (71cm to 96cm)
- Durable blue powder coat finish. High wear parts are chrome plated



PRS-21 // Super Lite Team Race Stand

Same great stability, versatility and features as the PRS-20, yet weighs only 13.5 lbs (6.2 kg), 35% less than the PRS-20. Built using the perfect combination of steel for strength in joints and pivots, and aluminum to save weight. The PRS-21 is the perfect stand to choose when size and weight are important. Ideal for the traveling mechanic or any mechanic whose got to have the best and lightest.

Storage and Travel Bag: BAG-20



PRS-20 Folded



PRS-20 mounted to rear dropouts



Just lift and the PCS-1 folds

PCS-1 // Home Mechanic Repair Stand

Incorporating many of the same features as our shop repair stands, the durable and dependable PCS-1 is a high quality stand designed specifically for the home mechanic. Our most popular repair stand year after year.

- Clamping height quickly adjusts from 53" to 67" (134cm to 170cm)
- Quick-adjusting spring clamp fits tubes up to 1-5/8" (41mm)
- Folds flat for easy storage
- Constructed of powder coated steel tubing for years of use
- Rubber feet are adjustable for uneven floors
- Replaceable jaw covers (#468G)
- Clamp rotates 360 degrees for easy access to any part of bike



PCS-4 // Deluxe Home Mechanic Repair Stand

The PCS-4 has all the features of the PCS-1, but adds our Adjustable Linkage Clamp (the same clamp used in our heavy duty shop stands) and a new leg stabilizing system that creates a rock-solid base to resist tipping. Perfect for heavier duty home use or light duty shop use.

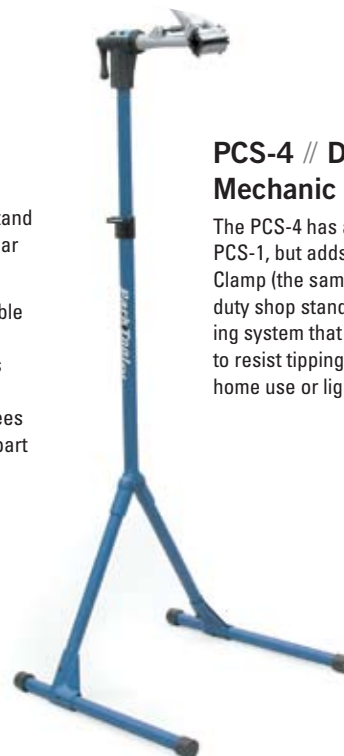

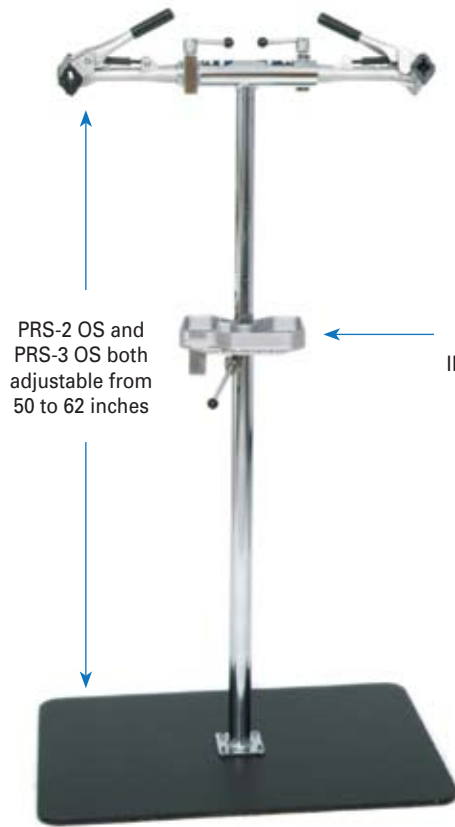

TOOL TRAY INCLUDED



100-6X // Extreme Range Clamp

Similar to 100-4X to fit PRS-5, PRS-7, PCS-4 with composite top tube, PCS-1 and PCS-2 made after 12/2001



100-15X // Extreme Range Clamp

Replacement Clamp for PRS-15 repair stand.

PRS-2 OS // Deluxe Double Arm Repair Stand

The standard for the past 30 years. Outstanding stability and a working height range of 50" to 62" (127-158cm)—high enough and stable enough to position the bike at a comfortable working height even when clamping on the seat post. The clamps rotate 360 degrees, allowing the bicycle to be positioned at any angle, and can be adjusted for frame tubes up to 1-5/8". Because the stand itself also rotates horizontally 360 degrees, one bicycle can be swung out of the way, allowing the other clamp to be used for "rush" repair jobs. The entire framework is heavily chrome plated and the steel base is painted. The stand is also available without the base (#PRS-20 SLB).

PRS-3 OS // Deluxe Single Arm Repair Stand

This stand is one-half of the Park Tool Deluxe Double Arm Repair Stand (PRS-2 OS), and incorporates most of the same features in a stand suitable for smaller areas. The clamp rotates 360 degrees and is adjustable for virtually any size frame tubing up to 1-5/8". Clamp height is adjustable from 50" to 62" (127-158cm). Uses larger diameter tubing and a 65 pound base to ensure a rigid working station. The PRS-3 OS is heavily chrome plated and is also available without the base (#PRS-30 SLB).

Tech Note

Clamping Tip: The clamps used on the PRS-2 OS, PRS-3 OS, PRS-4 OS and PRS-4W may be removed from the stand, and then clamped to the bike. Lift the bike and clamp together and insert into the stand.

100-4X // Extreme Range Clamp

Our most versatile clamp, the 100-4X fits our heavy duty shop stands and works on nearly any bike, no matter what the size or shape of the frame tube.

- Clamps oversized, square, rectangular, and even aero shaped tubes
- Quickly adjusts from 7/8" to 4"
- Pivots 90 degrees to clamp either top and bottom or left and right sides of tube
- Adjustable clamping pressure prevents damage to thin-walled tubes
- Narrow jaws for clamping in tight access areas
- Replaceable jaw covers (part #1259)
- Fits any PRS-2, PRS-2 OS, PRS-3, PRS-3 OS, PRS-4, PRS-4 OS, PRS-4W, PRS-11, or PRS-12 Repair Stand

PCS-EXT // Extension for PCS-1 Repair Stand

The PCS-EXT adds up to 21 inches of fully adjustable working height to the PCS-1 Home Mechanic Repair Stand. Positions bike at a comfortable working height—even when clamping on the seatpost. Quick release collar allows the height to be changed in seconds. Works on all PCS-1 Repair Stands using a composite top tube assembly. The PCS-EXT is included with all current PCS-1 Repair Stands.

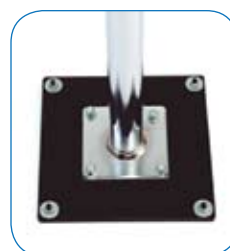

FP-2 // Floor Plate

Permanently and securely attach your Park Tool Repair Stand to the floor of your shop with our Floor Mounting Plate. Made with an 8" square of steel, it attaches to stand with four bolts, which are included.



PRS-4W // Deluxe Wall Mount Repair Stand

Designed to be easily mounted to any post or wall stud, the PRS-4W is a shop quality stand using the same clamp and locking system as the PRS-2 OS, PRS-3 OS, and PRS-4 OS. Powder coat finish. (Mounting bolts not included).

PCS-2 // Home Mechanic Bench Mount Repair Stand

This is the bench mount version of our popular Home Mechanic Repair Stand (PCS-1). It incorporates the same adjustable clamp and will rotate the bicycle 360 degrees, holding it steady at any angle. Durable powder coating. Mounts to any flat surface. (Mounting bolts not included).

PRS-7 // Bench Mount Repair Stand

Easily mounted on any workbench. Uses the same adjustable linkage clamp and locking system as the PCS-4. Mounting flange has four holes, allowing use of bolts or lag bolts to mount. Durable powder coated finish. (Mounting bolts not included).

PRS-4 OS // Deluxe Bench Mount Repair Stand

The Deluxe Bench Mount Stand uses the same clamp as the PRS-2 OS, PRS-3 OS, PRS-4W. The clamp rotates 360 degrees, allowing the bike to be positioned at any angle. Mounts easily to any flat surface. (Mounting bolts not included).



105 // Cast Aluminum Tool Tray*

The 105 is a handy and sturdy cast aluminum tray with deep-walled compartments and assorted slots for holding tools, lubes, and small parts. Fits all PRS-2, PRS-2 OS, PRS-3, PRS-3 OS, and PRS-13 Shop Stands, as well as PRS-6, PCS-1, and PCS-4 Repair Stands manufactured after 6/96.



TK-2 // Tool Kaddy*

This handy unit is perfect for storing frequently used tools right at your fingertips. The Tool Kaddy rotates to bring needed items up close, features deep pockets, and includes 12 hooks. The TK-2 mounts easily using the included mounting hardware on Park Tool Repair Stands PRS-2, 3, 4, 11, 12 and 13, including OS models.



104 // Work Tray*

This large tray is ideal for holding small parts and tools. It features deep sides so small items stay put. A variety of slots and holes hold any tool. Fits PCS-1, PCS-4, PCS-9, PCS-10, PCS-11, PRS-2, PRS-3, PRS-6, PRS-11 & PRS-12.



HBH-1 // Handlebar Holder

The Handlebar Holder is designed to hold the handlebars stationary, keeping the front wheel from "flopping" while the bike is worked on. It will hold the handlebar securely when the bicycle is rotated to any position in your Park Tool Repair Stand. Works on virtually all mountain and road bikes. Velcro® strap is included to attach the Handlebar Holder to the frame.



ISC-1 // Internal Seat Tube Clamp

Clamping directly onto frames made from carbon fiber and other ultra-thin materials can cause inadvertent frame damage. The ISC-1 is designed to allow you to hold frames securely without clamping onto a tube and to raise the bike to a more comfortable working height. To use, insert the ISC-1 into the seat tube, turn the knob to expand the tool, and then clamp into any Park Tool Repair Stand. Fits frames with seat tube diameters 25mm to 27.4mm.



* Tools not included

// Replacement Clamps

Replacement clamps fit frame tubes from 1" to 1-5/8" (25 to 41mm), allow for cable routing on the top tube, and feature replaceable jaw covers. 100-8C fits 15/16" to 1 1/4" (24mm to 33mm).



100-5C //

Adjustable Linkage Clamp fits PCS-4, PRS-5, PRS-6, and PRS-7 stands made after 6/96.

100-1C //

Spring Linkage Clamp fits PCS-1 and PCS-2 stands made after 6/96.

100-3C //

Adjustable Linkage Clamp fits PRS-2, PRS-2 OS, PRS-3, PRS-3 OS, PRS-4, PRS-4W and PRS-4 OS stands. Fits PRS-5 stands made before 6/96.



100-8C //

Spring Linkage Clamp fits PRS-6, PRS-7, and PRS-8 stands made before 6/96.

100-2C //

Spring Linkage Clamp fits PCS-1 and PCS-2 stands made before 6/96.

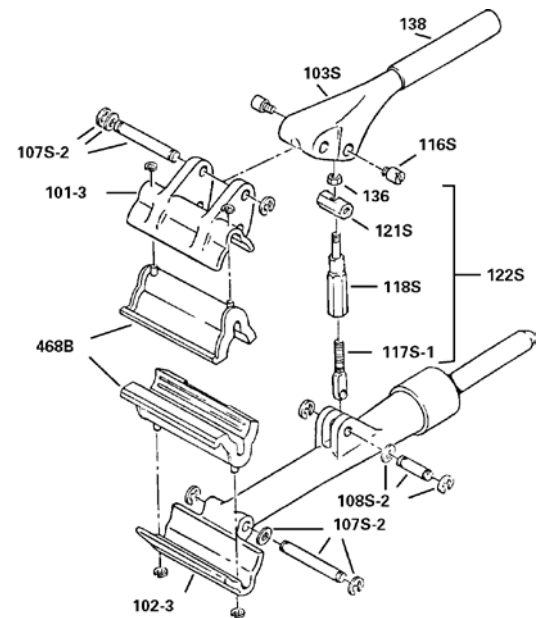

Tech Note

Park Tool makes two basic types of clamps: fully adjustable and spring linkage. The 100-3C, 100-5C, 100-4X, 100-6X and 100-15X Adjustable Clamps allow infinite adjustment of clamping pressure. There are some situations where the bike should be very firmly clamped, and others where very light pressure is needed, and these clamps allow this adjustment. In comparison, the 100-1C and 100-8C Spring Linkage Clamps rely on constant spring pressure. While fine adjustment of the pressure being applied to a tube is not possible, the spring linkage clamps are very simple and easy to use.

// Replacement Clamp Covers

Available in eight models to fit all Park Tool Repair Stand clamps.

- **468G:** Fits PCS-1 and PCS-2 with double cable reliefs.
- **488B:** Fits PRS-2 through PRS-8 and PCS-4 with double cable reliefs.
- **467B:** Fits PRS-2 through PRS-8 with single cable relief.
- **467G:** Fits PCS-1 and PCS-2 with single cable relief.
- **46:** Fits original clamps with plastic-dipped jaws. Old plastic should be removed before installing new covers.
- **1002:** Fits 100-3X and 100-5X clamp
- **1259:** Fits PRS-15, 100-4X, 100-6X and 100-15X clamps
- **1185K:** Fits PCS-9, PCS-10, PCS-11,

PRS-CRK // Repair Kit for 100-3C Clamp

Includes: (1) 122S, (2) 116S, (1) 108S-2, (2) 107S-2.

// Replacement Parts for Clamp 100-3C

- | | |
|--------|-------------------------------|
| 138 | Handlegrip |
| 117S-1 | Eyebolt |
| 103S | Handle |
| 107S-2 | Pin with washers and circlips |
| 118S | Adjusting barrel |
| 101-3 | Moveable jaw |
| 121S | Adjusting barrel pivot |
| 468B | Clamp cover set with circlips |
| 136 | Nut, 1/4-28 |
| 102-3 | Rotating shaft |
| 116S | Cap screw |
| 108S-2 | Pin w/washers and circlips |
| 122S | Linkage complete |



(TS-3 shown with 1555-1 Dial Indicator Set.)

TS-3 // Master Truing Stand

When only the best equipment will do, look no further than the TS-3 Truing Stand. Built to exacting specifications using the highest quality materials available, this stand delivers an unprecedented level of accuracy. You now can quantify the trueness of a wheel using the optional factory dial indicator package.

Designed from the ground up to be the new standard in truing stands, the TS-3 Truing Stand gives you all of these important features to assure you of absolute precision and accuracy.

1. The TS-3 Truing Stand will center (dish) a wheel, relative to the faces of the hub locknut, to within 0.25mm (0.01 inch).
2. The linear motion of the upright arms ensures superior alignment.
3. Optional dial indicators provide quantified measurement of radial and lateral run out allowing exact specifications to be maintained, and allowing strict adherence to shop and industry standards.
4. The angle of the TS-3 Truing Stand can be adjusted so it can be used comfortably by mechanics of different heights.
5. Precision ground parts and precise bearings ensure long-lasting, smooth operation.
6. The caliper arm moves quickly and easily saving time when mounting the wheel. The arm stores out of the way to prevent damage to the arm.

TS-3 // Stand only

1554-1 // Centering Gauge for TS-2 and TS-3 (included with TS-3)

1555-1 // Dial Indicator Set with brackets

1556-1 // Dial Indicator Bracket Set only (no dials)

In the U.S. the TS-3 and accessories are available only from:
Park Shop Service & Supply 888-568-4959



TS-8 // Home Mechanic Wheel Truing Stand

Designed especially for the home mechanic, the TS-8 allows accurate wheel truing at an economical price. Accepts wheels from 16" to 29", with or without the tire mounted. Innovative sliding dropout allows quick wheel installation, no matter what the hub width (up to 170mm). Dishing (centering) is performed by simply flipping the wheel in the stand. Constructed from heavy gauge steel to resist flexing, the TS-8 can be used freestanding or bolted to a bench for extra stability.



Phil McNaughton / Dr. Spoke / Stockholm, Sweden



TS-2EXT // Truing Stand Upright Extensions

TS-2EXT Truing Stand Upright Extensions install in seconds on any TS-2 Truing Stand, allowing the stand to be used on wheels with hubs up to 160mm wide (tandem and downhill bikes), as well as on 700C wheels with a 29" mountain bike tire installed. In addition, specially sized bosses on the TS-2EXT serve as adaptors so the TS-2 Truing Stand can be used with wheels using 20mm through axle hubs.



TSB-2 // Truing Stand Tilting Base

We've designed the Tilting Base specifically for use with our Park Tool TS-2 Professional Wheel Truing Stand. It allows for adjustment of the truing stand 20 degrees forward or backward for comfortable use at any bench height. The handy bins in the front of the Tilting Base are specially designed to hold Park Tool Spoke Wrenches and other small items such as spoke nipples. The bin corners are rounded to make even the smallest part easy to retrieve. Reinforced black nylon body will stand up to heavy use. Holes are provided for mounting to workbench or other surfaces for greater stability.



TS-2 // Professional Wheel Truing Stand

The Park Tool Professional Truing Stand is the stand to choose for heavy shop use. Accepts wheels from 16" to 27" with or without tire removed. Both axle-holding uprights move simultaneously, always centering wheel. Calipers and caliper arm are spring-loaded to prevent jamming with badly out-of-true wheels. Made of heavy chrome plated steel with nylon bushings at pivot points. Can be bench-mounted or vise-held. The standard of the industry. If a forward or backward tilt is desired, use with Truing Stand Tilting Base (TSB-2). For precision work, the TS-2 should be used with a dishing gauge.



WAG-4 // Wheel Alignment Gauge

For a wheel to perform properly, it is important for the rim to be centered between the locknuts of the hub, or “dished”. To check this, and to make precision adjustments, a wheel alignment gauge (also called a “dishing tool”) is a must. The WAG-4 allows easy checking of the dish on road, mountain, or BMX wheels from 16” to 29”. It works with any hub width and its innovative design even allows it to be accurately used with the tire still on the wheel. An accurate and truly versatile wheel alignment gauge that belongs along side every truing stand.

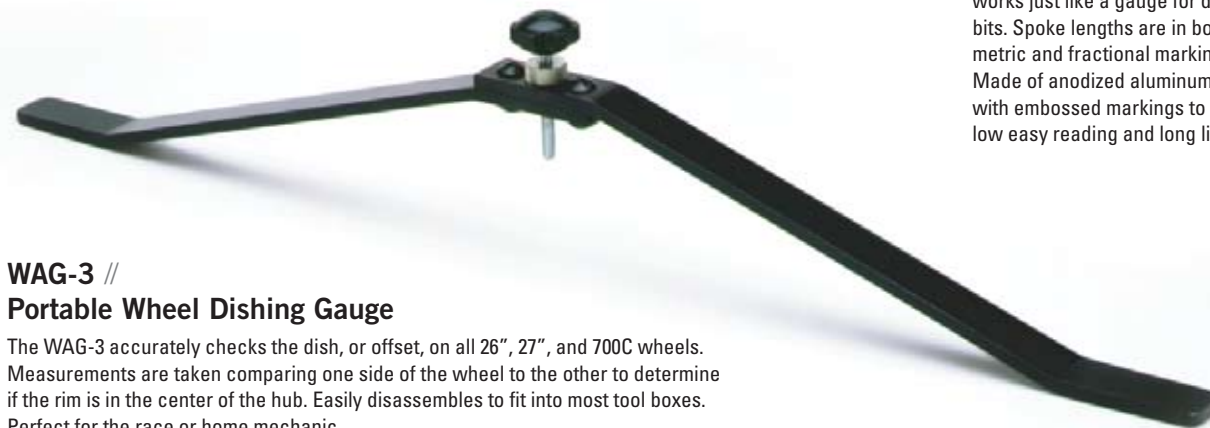

WAG-3 // Portable Wheel Dishing Gauge

The WAG-3 accurately checks the dish, or offset, on all 26”, 27”, and 700C wheels. Measurements are taken comparing one side of the wheel to the other to determine if the rim is in the center of the hub. Easily disassembles to fit into most tool boxes. Perfect for the race or home mechanic.

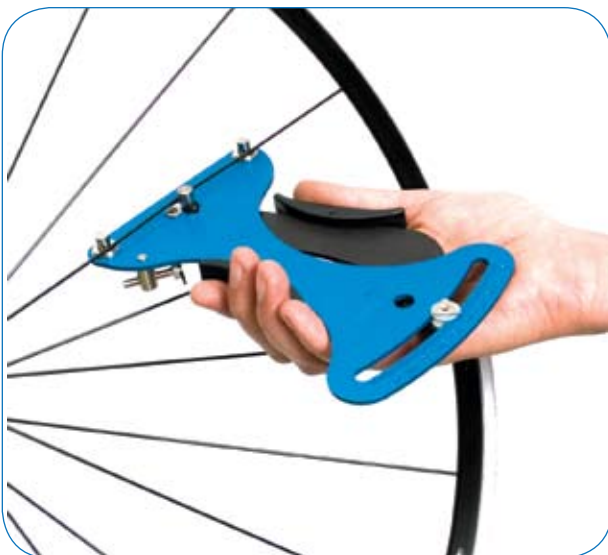

TM-1 // Spoke Tension Meter

The key to wheels that are strong and reliable is having spokes that are properly and uniformly tensioned. The TM-1 Tension Meter accurately and reliably measures the absolute tension of each of the spokes in a wheel, as well as the relative tension between all the spokes in a wheel. Easy to use and priced affordably, the TM-1 works on nearly any bicycle spoke—no matter what the diameter, material, or shape. Not just for the experienced mechanic, the TM-1 is for anyone building or truing wheels, diagnosing wheel problems, or assembling new bikes. It’s a tool that belongs on every workbench.

SBC-1 // Spoke, Bearing, & Cotter Gauge

This handy shop aid is ideal for sizing spokes, ball bearings and crank cotters. To use, just hang the head of the spoke in the oblong hole and read its length on the scale. For crank cotters and ball bearings it works just like a gauge for drill bits. Spoke lengths are in both metric and fractional markings. Made of anodized aluminum with embossed markings to allow easy reading and long life.



SW-0 through SW-3 // Spoke Wrenches

Professional quality, precision-sized spoke wrenches are hardened and nickel plated for long service. Park Tool Spoke Wrenches are vinyl coated in one of four colors indicating the size at a glance. Park Tool Spoke Wrenches are marked "Park Tool USA."

- SW-0 (Black)** // 80 ga./.127" nipple / 3.23mm
 - SW-1 (Green)** // 80 ga./.130" nipple / 3.30mm
 - SW-2 (Red)** // 80 ga./.136" nipple / 3.45mm
 - SW-3 (Blue)** // 105 ga./.156" nipple / 3.96mm
- Packaged carded: SW-0C through SW-2C**

BEWARE OF POOR FITTING IMITATIONS!



SW-10 // Adjustable Spoke Wrench

The SW-10 Adjustable Spoke Wrench helps remove tight (stubborn) or rounded nipples. Hardened, nickel plated investment casting gives superior strength and durability. Fits any of the 80 gauge sizes listed for SW-0 through SW-2.



SW-7 // Triple Spoke Wrench

The precision sized SW-7 fits the three most popular spoke nipple sizes on the market. Sizes equal to SW-0, 1, 2. The SW-7 is nickel plated for years of service. Designed for the home mechanic.

Packaged carded: SW-7C

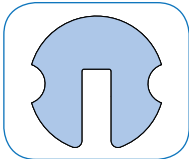

Spoke wrench bottom view



SW-13 // Spoke Wrench for Mavic® Wheel Systems

Comfortable, vinyl dipped, two-sided Spoke Wrench is designed to easily access Mavic fittings. Fits both Mavic 9mm threaded eyelets and 7mm integrated nipples.

Packaged carded: SW-13C



SW-14 // Spoke Wrench for Shimano® Wheel Systems

Two-sided and vinyl dipped, featuring 4.3mm and 4.4mm openings to fit all Shimano Wheel System nipples.

Packaged carded: SW-14C



SW-40 • SW-42 // Four Sided Spoke Wrench

Unique four-sided design provides extra strength and support and helps prevent slipping and deformation of Aluminum nipples. A different approach using the same world famous design and high quality materials as our three-sided spoke wrenches.

- SW-40 (Black)** // 80 ga./.127" nipple / 3.23mm
- SW-42 (Red)** // 80 ga./.136" nipple / 3.45mm

Packaged carded: SW-40C, SW-42C

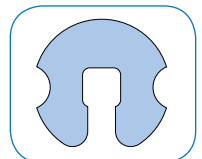

Spoke wrench bottom view



PTS-1 // Tire Seater

This tool is designed to quickly and easily “seat” stubborn tires. During inflation, tire beads often slip below the rim edge and are difficult to pull out. Simply place the non-slip jaws on the tire and lift out. The Park Tool Tire Seater adjusts to various tire widths. It’s chrome plated and the handles are vinyl coated for comfort.



TL-10 // Shop Tire Tool

Install and remove! The heavy duty TL-10 Shop Tire Tool quickly and easily removes almost any bicycle tire (20” and larger) from the rim and then mounts the tire with the same ease. The TL-10 simply hooks under the tire bead and then rotates around the rim to completely dismount the tire. To mount the tire, attach the installation portion of the tool and again just rotate around the rim. Save time with each tire repair you perform. Not a take-along tire lever, the TL-10 is a heavy-duty tire tool designed for use in the shop.



TL-5 // Heavy Duty Steel Tire Lever Set

The TL-5 Heavy Duty Tire Lever Set is designed for use on the toughest tire and rim combinations. Made of forged steel, these beefy levers are a full 8” (20.3 cm) long for superior leverage. Specially designed tip engages tire bead so it can be removed with just two levers. Ideal for difficult to remove downhill and freestyle tires. Set of two.

Packaged carded: TL-5C

TL-2 // Tire Lever Set

The thin and wide design of the TL-2 has more engagement with the bead of the tire so it can be “popped” off using just two levers. TL-2 is thinner and wider than the TL-1 and, therefore, it works differently. The TL-2 has more engagement with the bead of the tire so it can be “popped” off using just two levers. The TL-2 Tire Levers are very compact and lightweight, and because you only need two, they’re perfect for stashing in a jersey pocket or in the tight confines of a seat pack. Packaged in sets of two levers, carded.

Packaged carded: TL-2C



TR-1 // Tire & Tube Repair Kit

Our popular GP-2 Super Patch Kit and TL-1 Tire Levers packaged together as a kit. Three Tire Levers and a box with six patches and one piece of sandpaper on a blister card.

Packaged carded: TR-1C



TL-1 // Tire Lever Set

Sold in sets of three, Park Tool Tire Levers are made of nylon to ensure long life and damage-free operation. The unique design of the TL-1 actually lifts the tire away from the rim and keeps the tube from being pinched. These blue levers are available carded (TL-1C), or in a 25-set counter display.

Packaged carded: TL-1C
Display box: TL-1



TB-2 // Emergency Tire Boot



The fastest, easiest, and most secure way to repair a cut or worn tire sidewall. The all-new TB-2 is produced using a strong, waterproof vinyl membrane with fiber weave reinforcement to keep the inner tube in place. A super strong pressure sensitive adhesive assures the boot stays in place in any tire, road or mountain, high or low pressure. A true ride saver.

Packaged carded: TB-2C



GP-2 // Super Patch Kit

One of our most successful products ever! We worked with 3M to produce a self-adhesive tube patch that stretches, flexes, twists, and turns right along with the tube. No messy glue, no bulky packaging. Lightly roughen tube with the included sandpaper, clean, apply patch, and you're ready to go. Six patches with sandpaper in a neat little carry along box. Available individually carded (GP-2C) or in a handy 50 kit countertop display.

Packaged carded: GP-2C
Display box: GP-2



VP-1 // Vulcanizing Patch Kit

The VP-1 Patch Kit includes six thin and flexible patches with tapered edges to blend with the tube's profile. Four round patches are 25mm in diameter for smaller holes. Two oval patches, 25mm x 35mm, are for wider cuts. A tube of self-vulcanizing fluid bonds the patch to the tube at the molecular level. Each kit is packaged in a small plastic box with sandpaper for cleaning the tube and instructions. Available individually carded or in a handy 36 kit countertop display.

Packaged carded: VP-1C
Display box: VP-1





PFP-3 // Home Mechanic Floor Pump

The PFP-3 is a high performance, feature-packed pump at a great price. Perfect for the home mechanic.

- Smooth operating steel barrel
- Composite head fits Presta, Schrader, and Dunlop valves without switching internal parts
- Thumb lock creates an air-tight seal
- Industrial quality brass pressure gauge
- Gauge is mid-mounted for easy reading
- Reinforced high pressure hose
- Stable three-point composite base
- Includes inflating needle



Martin Pulpan / Scott Veloservis / Pardubice, Czech Republic



PFP-2 // Professional Mechanic Floor Pump

The PFP-2 is a shop quality pump for the professional mechanic. Packed with features and built for years of dependable service.

- Smooth operating double barrel design with anodized aluminum outer barrel
- Cast alloy head fits Presta, Schrader, and Dunlop valves without switching internal parts
- Cast alloy thumb lock creates an air-tight seal
- Oversized, ergonomically-designed handle with "soft-touch" rubber grips
- 2" industrial quality brass pressure gauge
- Gauge is mounted on top of pump for easy reading
- Extra long reinforced hose
- Oversized cast alloy base uses a three-point design and a non-skid rubber foot for superior stability
- Includes inflating needle

BK-2 // Roll-Up Workshop

The Park Tool Roll-Up Workshop supplies the home mechanic with almost all the specialty bike tools needed to repair and maintain most current model bikes. Add this kit to a few common household tools and the possibilities are endless. The Roll-Up Workshop includes a heavy weight nylon carrying case with 17 assorted tools, nylon and mesh storage pockets, grommets for hanging, and a super tough buckle to hold it all together. Perfect for bringing to the races or to rides for last minute repairs.



AK-32 // Advanced Mechanic Tool Kit

Designed specifically for the home mechanic that wants the best, the AK-32 Advanced Mechanic Tool Kit is a special 35-piece collection of our finest "shop quality" tools, all packaged in a tough tool box. The AK-32 includes all the most

frequently used tools, as well as some items a mechanic should not be without – basically, everything needed to perform most repair and maintenance tasks, from brake adjustments to headset overhauls, on the majority of current model bikes.



PPM-3 // Park Pack Mini Tool Kit

The PPM-3 is a collection of high quality tools that are lightweight, compact, and perfect for taking on rides. Includes CT-6 Folding Chain Tool, TL-1 Tire Levers, Double-Ended Spoke Wrench, #297 Open End Wrench (8, 9, 10mm), IB-1 Mini Fold Up Hex Wrench/Screwdriver Set, GP-2 Pre-Glued Patch Kit, and TB-1 Tire Boot. The tools all fit neatly into a nylon tool wallet that slips easily into a jersey pocket or seat pack.

Packaged carded: PPM-3

WTK-1 // Essential Tool Kit

Designed for the casual cyclist, the economical WTK-1 contains the tools needed for many basic adjustments and repairs at home or on the road. Includes: 3, 4, 5, 6mm hex wrenches; tire levers; patch kit; straight blade screwdriver, and a small adjustable wrench—all housed in a compact, ready-to-go tool wallet.

Packaged carded: WTK-1C



PK-57 // Professional Tool Kit

Designed as a “do it all” kit for the home mechanic or as a solid starter kit for the professional shop mechanic, the PK-57 is a very special 59 piece collection of our very finest shop tools. While it includes the tools needed to perform almost any basic repair or adjustment on the bike, the PK-57 also includes the specialty tools to perform many advanced repair tasks, such as installing and removing headset

races, installing crown races, cutting fork steerer tubes, straightening derailleur hangers, tapping threaded frame braze-ons, dishing wheels, and more. The entire kit comes in a tough, oversized toolbox, which has plenty of extra room for additional tools and spare parts.



RK-41 // Portable Race / Ride Kit

A custom built backpack that transforms into a portable workstation right before your eyes. We've built the ultimate event kit using the latest backpack technology and the best tools available.

- Secure tool holders, pockets and straps specifically designed to hold and transport the most used tools.
- A large, open interior, a variety of extra utility pockets and flexible compression netting designed to secure odd shaped items.
- Ingenious fold out interior creates a convenient tool board that makes it easy to set up a workstation at any race, ride or home workshop.
- Padded shoulder straps and waist belt distribute the weight evenly and make transport a breeze.
- Forty-one Park Tool brand specialty and general hand tools, designed to tackle a huge variety of mechanical and maintenance procedures.

BW-1 // Backpack Workstation

Same great backpack as the RK-41 without the tools. Choose your own set, or fill the BW-1 with tools you already own.

Patent Pending



NEW



MK-129 // Master Mechanic Tool Set

Big Kahuna, The Real Deal, Big Ticket, The Chief, El Grande, Fat Cat, The Grand Poobah, All The Marbles, The Real Mac Daddy, The Big Show, The King, The Whole Shootin' Match... Whatever you call it, this is it! The tool set... to end all tool sets. Pretty much anything and everything we could think of is included in this collection. Designed for the professional, full service mechanic the MK-129 is a

complete set of professional level tools, fixtures, lubricants, gauges, and accessories. The perfect way to start a repair business, open or expand a bike shop, or create the ultimate home workshop. Over 120 shop quality tools from the only company in the world capable of such a feat. Tool Envy. It's a beautiful thing!

NEW



// Screwdrivers

Shop quality screwdrivers designed for comfort and durability. Featuring dual density grips and heat-treated, chrome vanadium tips and shafts.

SD-0 // #0 Phillips • SD-2 // #2 Phillips • SD-6 // 6mm flat blade



NEW

PAW-12 // 12" Adjustable Wrench

Big and powerful, the PAW-12 is forged from Carbon Steel, chrome plated, and features a comfortable vinyl dipped handle. Jaws open to 36mm and feature a laser engraved measurement scale.



NEW

HMR-1 // Shop Hammer

We've designed the perfect shop hammer! The HMR-1 is built with a fiberglass, reinforced shaft and a soft-touch rubber hand grip. A unique, two-sided head with both a steel and a rubber striking surface made specifically for bike shop use.



RR-12 // Tape Measure

NEW

Small and handy, the RR-12 features a tough, composite housing and both Metric and English readings up to 12 feet (3.65 M).

Packaged carded: RR-12C

// TOOLS IN KITS

Park #	Tool	BK-2	AK-32	PK-57	MK-129	RK-41
690-XL	Facing Cutter For Low Profile Headsets - For HTR-1				X	
750	Centering Cone Adaptor - For HTR-1				X	
754	33.8mm (1-1/8") Reamer - For HTR-1				X	
768	43.8mm Pilot - For HTR-1				X	
769	Head Tube Reaming Extension - For HTR-1				X	
AWS-1	Hex Wrench Set, 4, 5, 6mm					X
AWS-10	Hex Set, 1.5, 2, 2.5, 3, 4, 5, 6mm	X			X	X
AWS-12	Fold-up Metric/Fractional Hex Wrench Set				X	
BBT-2	Cartridge Bottom Bracket Tool for Shimano® and Isis®	X	X	X	X	X
BBT-4	Bottom Bracket Tool - Campi Veloce, Mirage, Centaur				X	X
BBT-5	Bottom Bracket/ Cassette Locking Tool for Campagnolo®			X	X	X
BBT-7	Lockring Wrench - XTR and Dura Ace				X	
BBT-8	Chaining Lockring/ Bottom Bracket Tool		X	X	X	
BBT-9	Bottom Bracket Tool - Hollowtech II				X	X
BCB-4	Bike Cleaning Brush Set				X	
BFS-1	Bottom Bracket Facing Set				X	
BO-1	Bottle Opener					X
BT-2	Fourth Hand Brake Tool			X	X	
BT-3	Brake Toe-in-Tool				X	
BT-5	Adjustable Third Hand Brake Tool				X	
BTS-1	Bottom Bracket Tapping and Facing Set				X	
CBW-1	Open End Wrench, 8/10mm	X	X	X	X	X
CBW-4	Open End Wrench, 9/11mm	X	X	X	X	X
CC-2	Chain Checker			X	X	
CC-3	Chain Wear Indicator		X		X	
CCP-2	Crank Puller for Square Hole Crank Arms			X	X	
CCP-4	Crank Puller for Splined Crank Arms			X	X	
CCW-5	Crank Bolt Wrench			X	X	X
CF-2	Heavy Duty Cutting Fluid: 8 oz. (237mL)					
CL-1	Synthetic Chain Lube: 4 oz. (118 mL)				X	X
CM-5	Cyclone® Chain Scrubber		X	X		
CN-10	Cable & Housing Cutter	X	X	X	X	X
CNW-1	Chaining Nut Wrench		X	X	X	
CRC-1	Crown Race Cutting Tool				X	
CRP-1	Universal Crown Race Puller				X	
CRS-1	Crown Race Setting System			X	X	
CT-3	Screw Type Chain Tool		X	X	X	
CT-5	Mini ChainBrute® Chain Tool	X				
CT-6	Folding Chain Tool					X
CT-7	Screw Type Chain Tool - For BMX and Freestyle				X	
CTP	Replacement Chain Tool Pin				5	
CWP-6	Universal Crank Puller and 8mm Wrench	X	X			X
DAG-1	Derailleur Alignment Gauge			X	X	
DCW-1	Cone Wrench, 13/14mm	X				X
DCW-3	Cone Wrench, 15/16mm					X
DCW-4	Cone Wrench, 13/15mm					X
DCW-2	Cone Wrench, 15/16mm	X				
DT-1	Disc Mounting Facing Tool				X	
DT-2	Rotor Truing Fork				X	
DT-3	Rotor Truing Gauge				X	
FAG-2	Frame Alignment Gauge				X	
FFG-1	Frame and Fork End Alignment Gauge Set				X	
FFS-2	Handlebar and Subframe Straightener				X	
FR-1	Freewheel Remover: Shimano, Sachs Aris, Sun Race				X	
FR-2	Freewheel Remover: Sun Tour 2 Notch				X	
FR-3	Freewheel Remover: Sun Tour 4 Notch since 1986				X	
FR-4	Freewheel Remover: Atom, Regina, splined Zeus				X	
FR-5	Cassette locking tool for Shimano®, SRAM® etc.	X	X	X	X	X
FR-5G	Cassette Locking Tool with Guide Pin				X	
FR-6	Freewheel Remover: BMX				X	
FR-7	Freewheel Remover: Falcon				X	
FR-8	Freewheel Remover: BMX freewheels with 30x1mm threads				X	
FRW-1	Freewheel Remover Wrench				X	
FTS-1	Fork Threading Set				X	
HBH-1	Handlebar Holder				X	
GP-2	Super Patch Kit	X	X	X		X
GSC-1	GearClean® Brush	X	X	X		
HCW-4	Box-End 36mm and Bottom Bracket Pin Spanner			X		
HCW-7	30mm and 32mm Head Wrench				X	
HCW-9	36mm and 40mm "Oversize" Head Wrench				X	
HCW-15	36/32mm Headset Wrench	X	2	X		X
HCW-16	Chain Whip/ 15mm Pedal Wrench	X				X

Park #	Tool	BK-2	AK-32	PK-57	MK-129	RK-41
HHP-2	Bearing Cup Press			X	X	
HMR-1	Shop Hammer				X	X
HR-10	Hex Wrench 10mm					X
HTR-10	Head Tube Reaming and Facing Set				X	
HHP-2	Bearing Cup Press			X		
HR-8	8mm Hex Wrench		X			
HW-2	Professional Headset Locknut Wrench 32mm and 36mm			X	X	
ISC-1	Internal Seat Tube Clamp: 25mm and up				X	
KS-1	Kickstand Tool				X	
MB-1	Magnetic Bowl				X	
MLP-1	Master Link Pliers				X	X
OBW-1	Offset Brake Wrench: 10mm, 13mm				X	
PAW-12	Adjustable Wrench: 12"				X	X
PH-1	P-Handled Hex Wrench Set w/ Holder (Set of 8)			X	X	
PH-11,12	P-Handled Hex Wrench: 11mm,12MM				X	
PH-T25	P-Handled T25 Wrench				X	
PPL-1	PolyLube 1000 Lubricant, 4 oz.		X			X
PPL-2	PolyLube 1000 Grease in one pound tube			X	X	
PTS-1	Tire Seating Tool				X	
PW-3	Pedal Wrench		X			
PW-4	Professional Pedal Wrench			X	X	
RR-1	Tape Measure				X	
RT-1	Headset Cup Remover			X	X	
RT-2	Steering Race Remover				X	
SA-3	Heavy Duty Shop Apron			X	X	
SBC-1	Spoke, Bearing, & Cotter Gauge		X	X	X	
SCW-SET	Shop Cone Wrench, Set of 7: 13,14,15,16,17,18,19mm		X	X	X	
SCW-20	Shop Cone Wrench: 20mm				X	
SD-0	Shop Screwdriver: #0 Phillips				X	X
SD-2	Shop Screwdriver: #2 Phillips				X	X
SD-6	Shop Screwdriver: 6mm Flat Blade				X	X
SG-1	Saw Guide: 1" x 24 Thread				X	
SG-2	Saw Guide: 1-1/8" x 26 Thread				X	
SG-6	Threadless Saw Guide			X	X	
SPA-1	Hanger Cup Pin Spanner				X	
SPA-2	Cluster Cone Pin Spanner				X	
SPA-4	Hanger Cone Spanner				X	
SPA-6	Adjustable Pin Spanner				X	
SR-1	Chain Whip/Freewheel & Lockring Remover		X			
SR-2	Professional Sprocket Remover / Chain Whip			X	X	
STL-1	Park Tool Shop Stool with Swivel				X	
SW-0	Precision Spoke Wrench, 80 Ga./127		X	X	X	X
SW-1	Precision Spoke Wrench, 80 Ga./130		X	X	X	X
SW-2	Precision Spoke Wrench, 80 Ga./136		X	X	X	X
SW-3	Spoke Wrench (Blue): .156"				X	
SW-7	Triple Spoke Wrench, 80 Ga./127, 130, 136		X		X	
SW-13	Spoke Wrench for Mavic Wheel Systems				X	
SW-14	Spoke Wrench for Shimano Wheel Systems				X	
SW-40	Four Sided Spoke Wrench: .127"				X	
SW-42	Four Sided Spoke Wrench: .136"				X	
TAP-3	Pedal Tap Set: 1/2" Right and Left				X	
TAP-6	Pedal Tap Set: 9/16" Right and Left				X	
TAP-7	Tap For Rear Wheel Dropout Alignment Screws 3mm x .5			X	X	
TAP-8	Tap For Water Bottle, Toe Clip, Fender, & Rack Bosses 5mm x .8			X	X	
TAP-9	Tap For Cantilever Brake Bosses 6mm x 1mm			X	X	
TAP-10	Tap for Derailleur Hanger 10mm x 1mm			X	X	
TB-2	Tire Boot - Set of 3		X	X	X	X
TL-1	Tire Levers - Set of 3 - carded	X	X	X	X	X
TL-2	Tire Levers - Set of 2 - carded				X	
TL-5	Heavy Duty Steel Tire Levers - Set of 2 - carded				X	
TL-10	Shop Tire Lever			X	X	
TM-1	Spoke Tension Meter				X	
TNS-1	Threadless Nut Setter			X	X	
TS-2	Professional Wheel Truing Stand				X	
TSB-2	Truing Stand Tilting Base - For TS-2				X	
TS-2EXT	Truing Stand Upright Extensions - For TS-2				X	
TW-1	Torque Wrench: 1/4" drive, 0-60 inch pounds				X	
TW-2	Torque Wrench: 3/8" drive, 0-600 inch pounds				X	
TWS-2	Fold-up Wrench Set: T7,T9,T10,T15,T20,T25,T27,T30,T40				X	X
UK-1	Utility Knife				X	X
WAG-3	Wheel Alignment Gauge			X	X	

NEW

MB-1 // Magnetic Parts Bowl

This bench top accessory keeps small parts accessible and all in one place. 6" (15cm) in diameter and featuring an extra strong magnet, the MB-1 is available only in World Famous Park Tool Blue.



NEW

UK-1 // Utility Knife

It folds, it cuts, it hangs on your belt and best of all... it's blue. Perfect for the shop, garage, toolbox or saddlebag. The UK-1 is a combination of aluminum and stainless steel and uses readily available hardware store utility knife blades. It also features a secure, quick-change blade system that locks open and closed.

Packaged carded: UK-1C





IB-1 // I-Beam Mini Fold Up HexWrench / Screwdriver Set

Perfect for taking on rides, the strong, compact, lightweight IB-1 features our unique I-Beam handle surrounded by 3, 4, 5, 6 and 8mm hex wrenches and a straight blade screwdriver.

Packaged carded: IB-1C

Ask your supplier about our custom laser engraving program for IB tools. Your logo along for every ride.

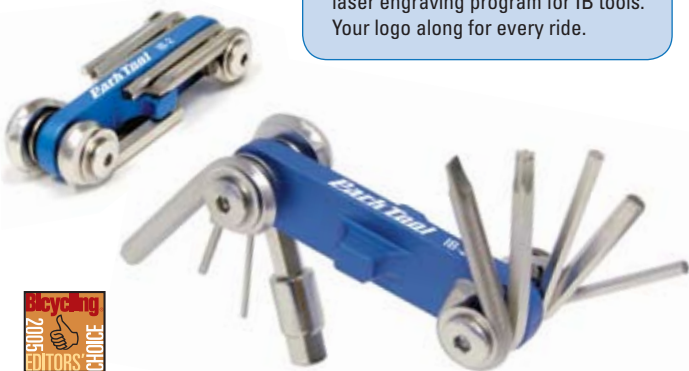

IB-2 // I-Beam Mini Fold Up Hex Wrench / Screwdriver / Star Driver Set

The IB-2 features our unique I-Beam handle with 1.5, 2, 2.5, 3, 4, 5, 6, & 8mm hex wrenches; a T25 Star driver wrench; and a straight blade screwdriver. Strong, compact, and lightweight, the IB-2 is a great tool for taking on the road or trail.

Packaged carded: IB-2C



IB-3 // I-Beam Mini Fold-Up with Chain Tool

A complete take-along tool combining our award winning I-Beam technology with a full complement of emergency tools. The IB-3 includes all the tools included in the IB-2 plus a composite wrapped tire lever, spoke wrenches and a 10-speed compatible chain tool. A portable workshop designed to get you back on the bike!

Packaged carded: IB-3C



MTB-3 // Rescue Tool

The MTB-3 Rescue Tool is a premium quality multi-tool with the design and innovative features you'd expect from the top name in bicycle tools. Small and light enough to slip into a pocket or seat pack, the MTB-3 contains 22 tools, each carefully selected for nearly any repair on the road or trail. Manufactured to the highest standards, all tools are finely polished stainless steel or nickel plated steel. Unique three-piece design (patent # 6,622,329) makes each tool easy to access and easy to use. Super tough nylon handles provide excellent grip when using tools. Includes nylon carrying case with embroidered Park Tool logo. Tools included:

- Chain tool
- Tire levers (2)
- Phillips head screwdriver
- Straight blade screwdriver
- T25 star-shaped driver
- 1.5, 2, 2.5, 3, 4, 5, 6, & 8mm hex wrenches
- 8, 9, and 10mm box end wrenches
- Bottle opener
- .127", .130", & .136" spoke wrenches
- Pedal wrench
- Serrated knife

Packaged carded: MTB-3C



MTB-7 // Rescue Tool

An outstanding value, the quality MTB-7 Rescue Tool is packed with 21 useful tools for emergency repairs on the road or trail. Includes nylon carrying case with embroidered Park Tool logo. Tools included:

- 2, 2.5, 3, 4, 5, 6, & 8mm hex wrenches
- Tire levers (2)
- Phillips head screwdriver
- Straight blade screwdriver
- T25 star-shaped driver
- .127", .130", & .136" spoke wrenches
- 8, 9, & 10mm box end wrenches
- Chaining nut wrench
- Dust cap remover
- Serrated knife
- Bottle opener

Packaged carded: MTB-7C



TWS-2 // Star-Shaped Wrench Set

The use of Star-shaped fittings on disc brakes, pedals, chainring bolts, etc. are becoming increasingly popular. The TWS-2 combines the wrench sizes currently being used on bicycle components (T7, T9, T10, T15, T20, T25, T27, T30 and T40) in a convenient fold-up set. Composite handle is extremely strong (stronger than steel handles), comfortable to use, and slip resistant.

Packaged Carded: TWS-2C



// Fold Up Hex Wrench Sets

Park Tool Fold Up Hex Wrench Sets use a multi-position composite handle that is comfortable, lightweight, slip-resistant, and 40% stronger than steel handles. Hexes have chamfered tips for a perfect fit and are made from Bondhus Protanium™ high torque industrial steel for long life.

AWS-9 // 4mm, 5mm, and 6mm Hex Wrench Set with Phillips and straight blade screwdrivers

Packaged carded:
AWS-9C

AWS-10 // 1.5mm, 2mm, 2.5mm, 3mm, 4mm, 5mm, & 6mm Hex Wrench Set

Packaged carded:
AWS-10C

AWS-11 // 3mm, 4mm, 5mm, 6mm, 8mm, & 10mm Hex Wrench Set

Packaged carded:
AWS-11C

AWS-12 // 2mm, 3mm, 4mm, 5mm, 6mm, 3/16", 7/32", & 1/4" Hex Wrench Set

Packaged carded:
AWS-12C



MT-1 // Multi-Tool

The MT-1 is a high quality multi-tool that is uncomplicated, easy to use, and effective. Made of investment cast steel and electroless nickel plated for durability, the MT-1 features 3mm, 4mm, 5mm, 6mm, and 8mm hex wrenches; 8mm, 9mm, and 10mm socket wrenches; and a straight blade screwdriver. Each of the nine tools is carefully positioned so the MT-1 can be effectively used on those "tough to get to" nuts, bolts, and screws.

Packaged carded: MT-1C



PH-1 // P-Handled Hex Wrench Set with Bench Mount / Wall Mount Wrench Holder

These thoughtfully designed P-handled hex wrenches fit the task at hand, as well as they fit in your hand. The long shaft of each wrench is fitted with a Bondhus Balldriver for those hard to reach bolt heads. The short end of the wrench is neatly chamfered and extends from the handle for use when fully tightening bolts in high torque applications. Shaft lengths are optimally selected to minimize the wind-up and flex experienced with longer wrenches. The hex wrenches are made from Bondhus Protanium™ high torque industrial steel for long life. Special “speed bearing” attachment facilitates installation and removal of long-threaded socket head bolts and nuts. The offset P-handles are made from a durable nylon material and are ergonomically-designed for comfortable use. All the wrenches fit neatly in the included bench mount/wall mount holder. The PH-1 set includes 2, 2.5, 3, 4, 5, 6, 8 and 10mm sizes.

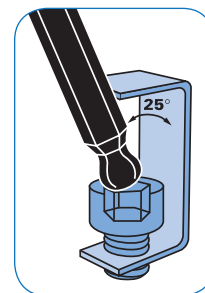

PH-2 // 2mm P-Handle Hex Wrench

PH-2.5 // 2.5mm P-Handle Hex Wrench

PH-3 // 3mm P-Handle Hex Wrench

PH-4 // 4mm P-Handle Hex Wrench

PH-5 // 5mm P-Handle Hex Wrench

PH-6 // 6mm P-Handle Hex Wrench

PH-8 // 8mm P-Handle Hex Wrench

PH-10 // 10mm P-Handle Hex Wrench

PH-11 // 11mm P-Handle Hex Wrench

PH-12 // 12mm P-Handle Hex Wrench



PH-T25 // P-Handled T25 Star-Shaped Wrench

Our comfortable P-handle with a T25 Wrench for the T25 bolt heads found on many disc brake calipers and rotors. Includes “Speed Bearing” attachment for fast installation and removal of long threaded bolts. Wrench is made from Bondhus Protanium™ high torque industrial steel for long life.

HXS-1 // Professional L-Shaped Hex Wrench Set

The same shop quality L-shaped hex wrenches as the HXS-2, but without the bench mount/wall mount holder.



HXS-2 // L-Shaped Hex Wrench Set with Holder

These shop quality L-shaped hex wrenches have a genuine Bondhus® balldriver tip on the long arm (excluding 8 and 10mm) for hard to reach bolt heads and a straight tip on the short arm for high torque applications. Wrench tips are precision chamfered for a clean, tight fit. Special "speed bearing" attachment facilitates installation and removal of long-threaded bolts. Wrenches are made from industrial quality Bondhus Protanium™ high torque steel. Set includes 2, 2.5, 3, 4, 5, 6, 8, and 10mm sizes. Bench mount/ wall mount holder keeps wrenches organized and is fan-shaped for easy access to all wrench sizes.



HR-8 // 8mm Hex Wrench

A long-handled L-shaped wrench for installing and removing crank bolts with an 8mm socket. Made from industrial quality Bondhus Protanium™ high torque steel. "Speed Bearing" attachment for quick installation and removal of long threaded bolts.

Packaged of carded: HR-8C



HR-11 • HR-12 // 11mm & 12mm Hex Wrenches

11 and 12mm hex wrenches are necessary for removing the freehub bodies from several popular brands of hubs (Mavic, Sun Race, Sovos, and others). Park Tool HR-11 and HR-12 are made from Bondhus Protanium™ industrial quality steel with chamfered tips for a precision fit.



Cat Gruner-Goss & John Barnett / Barnett Bicycle Institute / Colorado Springs, Colorado



// 3-Way Hex Wrench Sets

Park Tool introduced the bicycle industry to the 3-way Hex Wrench Set more than 20 years ago. Our latest versions are stronger and more comfortable than ever. They fit perfectly in the palm of the hand and provide tremendous leverage. Hexes are made from Bondhus Protanium™ high torque industrial steel and are heat-treated for long life. Tips of hexes are chamfered for a perfect fit.

AWS-1 // Blue

4mm, 5mm, & 6mm
Hex Wrench Set.

Packaged Carded: AWS-1C

AWS-3 // Green

2mm, 2.5mm, & 3mm
Hex Wrench Set.

Packaged Carded: AWS-3C

AWS-8 // Black

4mm, 5mm, & 6mm Hex
Wrench Set with balldriver tips.

Packaged carded: AWS-8C

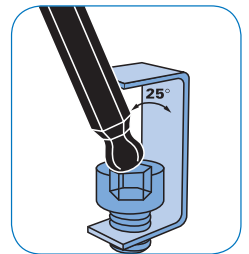

Nick Budden / Barlows Cycles /
St. Austell, United Kingdom



SR-1 // Sprocket Remover / Chain Whip

This combination chain whip and freewheel / locking remover wrench is heat treated to prevent bending and flexing. It also features hardened pins to keep the chain in place and a comfortable handle. Hex opening fits Park Tool freewheel removers.



SR-2 // Sprocket Remover / Chain Whip

This shop quality chain whip gives you incredible leverage without worry of slippage. Heavy duty, heat treated head with a round vinyl coated handle. Hardened bolts hold securely and make chain replacement easy.

FR-1 through FR-8 // Freewheel Removers

Heat treated alloy steel, one inch base fits wrench or bench vise. Thin wall construction allows use without removal of cones and locknuts.

Packaged Carded: FR-1C through FR-8C, BBT-5C



FR-1 //
Fits Shimano®, Sachs Aris®, and Sun Race® freewheels.



FR-2 //
Fits Sun Tour® two notch freewheels. Not recommended for Sun Tour four to six notch freewheels



FR-3 //
Fits all Sun Tour four notch freewheels since 1986.



FR-4 //
Fits Atom®, Regina®, splined Zeus®, and some Schwinn Approved® freewheels.



FR-5 //
Fits Shimano®, SRAM®, SunRace®, SunTour®, Chris King® and other cassette lockrings. Also fits Shimano disc brake lockrings.



FR-6 //
Removes four-notch BMX / single-speed freewheels from hubs with 1.37 x 24 TPI threads.



FR-7 //
Fits Falcon® freewheels



FR-8 //
Removes four-notch freewheels from "flip-flop" BMX hubs with 30 x 1mm threads.



BBT-5 //
Fits Campagnolo® cassette lockrings and Campagnolo® Record™, Chorus™, and Athena™ bottom brackets.



HCW-16 // Chain Whip / 15mm Pedal Wrench

10 Speed Compatible

FRW-1 // Freewheel Remover Wrench

This tool securely holds freewheel and locking tools (FR-1 through FR-8) for removal and installation. Features an investment cast head with locking knob and a long, round, vinyl dipped handle for superior leverage.



FR-5G //
Fits Shimano®, SRAM®, SunRace®, SunTour®, Chris King® and other cassette lockrings. Also Fits Shimano disc brake lockrings. Guide pin stabilizes tool.

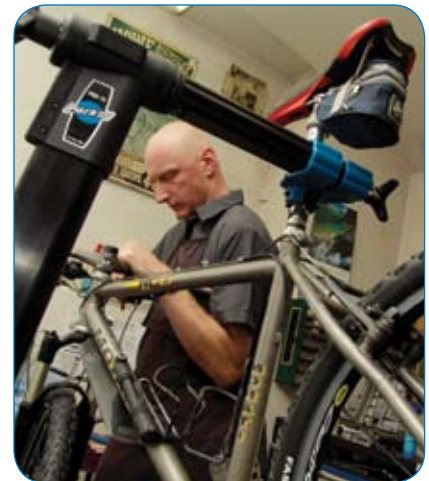

Jan Pristoupil / Dlouhan Works / Prague, Czech Republic



SCW-13 through SCW-20 // Shop Cone Wrenches

The standard of the industry, Park Tool Shop Cone Wrenches are unmatched in quality and performance. The special "Y" head design puts more material where it's needed for strength and durability. Precision sizing and a military grade industrial phosphate finish ensure an accurate fit and consistent quality. Thin enough to use on the narrowest of adjusting cones, the SCW Shop Cone Wrenches have a long, vinyl dipped handle for leverage and comfortable use. Sizes 13mm to 20mm, SCW-13 through SCW-20.



SCW-SET // Shop Cone Wrench Set

The SCW-SET includes SCW-13 to SCW-19

DCW-1, 2, 3, 4 // Double-Ended Cone Wrenches

These cone wrenches are designed for the home mechanic or occasional user. They're made of thin steel and are nickel plated and heat treated for long use. Available in four popular sizes from 13mm to 18mm. Their small size makes them ideal to carry along for quick repairs.

- DCW-1 // 13mm & 14mm
- DCW-2 // 15mm & 16mm
- DCW-3 // 17mm & 18mm
- DCW-4 // 13mm & 15mm

Packaged carded:
DCW-1C through DCW-4C



AV-4 // Heavy Duty Axle & Pedal Vise

Designed to securely hold 5/16" to 9/16" axles for easy wheel hub and pedal adjustments, the AV-4 is a must for every mechanic's workbench. Just insert axle into one of the three precision-machined openings and tighten in a bench vise.

The AV-4's bridge spring keeps the jaws aligned and allows the tool to automatically open when the bench vise is opened. Aluminum jaws won't damage axle threads.



AV-1 // Axle Vise

This tool holds the axle so it will not turn while work is done on the hub. It has two different diameter receptacles so it will work on front and rear axles. It is simple to use - just insert the axle into the proper diameter opening and tighten the bench vise. The jaws will open automatically when the vise is opened.



BBT-5 // Bottom Bracket / Cassette Tool for Campagnolo®

The BBT-5 fits 12-tooth internally splined Campagnolo®, Record®, Chorus®, and Athena® bottom bracket cartridges and all Campagnolo® cassette lockrings.

Packaged carded: BBT-5C



BBT-2 // Cartridge Bottom Bracket Tool for Shimano® & ISIS

The BBT-2 fits 20-tooth internally splined Shimano® and ISIS drive cartridge bottom brackets, including those with oversized spindles. Simply insert the BBT-2 into the splined cartridge and either tighten or loosen using a 3/8 inch ratchet driver or a 32mm wrench.

Packaged carded: BBT-2C

BBT-8 // Chainring Lockring & Bottom Bracket Tool

The BBT-8 Bottom Bracket Tool is used for installing and removing 8-notch Shimano® XTR M950 and Truvativ® ISIS Drive® bottom bracket cups. Also fits 8-notch chainring adapter lockring on some Shimano® and Truvativ® cranksets.

Packaged carded: BBT-8C



SPA-6 // Adjustable Spanner

This spanner uses hardened, replaceable pins. Designed for heavy-duty use, the distance between pins is adjustable, allowing use on virtually any hanger cup.

Packaged carded: SPA-6C
Replacement Pins 1501:
Replacement pins for SPA-6 and HCW-4.



BBT-4 // Bottom Bracket Tool

The BBT-4 is made for the installation and removal of 6-notch cartridge cups used on Campagnolo® Veloce®, Mirage®, Centaur®, Daytona® and Avanti® sealed cartridge bottom brackets. The handle is vinyl coated for comfort.



BBT-9 // Bottom Bracket Tool

The BBT-9 is used to remove and install Shimano® Hollowtech II bottom brackets. One end of the BBT-9 securely engages the 16 notches of the bottom bracket cups, while the other end engages the 8 internal splines of the crank arm adjustment cap. Also fits Truvativ® Giga X-Pipes, Race Face® X-type and FSA Mega® EXO bottom bracket cups.



BBT-7 // Lockring Wrench

The BBT-7 Lockring Wrench is used for installing and removing the lockring used on Dura Ace® 7700 and XTR® 950 Bottom Brackets. It is laser cut and engages five of the lockring's six notches for a precise, secure fit. The handle is vinyl dipped for comfort. While made specifically to fit Dura Ace® and XTR® Lockrings, it also fits several other lockrings as well.

Tech Note

What specific tools are needed to work on that Bottom Bracket?

Bottom Bracket Brand & Model	Park Tool
Shimano® cartridge bottom brackets and Dura-Ace 7703	BBT-2
Shimano® Hollowtech II, Truvativ® Giga X-Pipe, Race Face® X-type, FSA® Megaexo	BBT-9
Shimano® Dura-Ace® 7700 (adjustable type)	BBT-7 & BBT-2
Shimano® XTR® M950 (adjustable type)	BBT-7 & BBT-8
Shimano® XTR® M952 (cartridge type)	BBT-2
Campagnolo® Record, Chorus, Athena	BBT-5
Campagnolo® Daytona, Veloce, Mirage, Avanti, Centaur, Xenon	BBT-4
Sachs®, Thun SKF®	BBT-4
Truvativ® ISIS Drive®	BBT-8
Truvativ® square spindle type	BBT-2
Race Face® ISIS Drive® and FSA® ISIS Drive®	BBT-2
Real®	BBT-8
Syncros®	BBT-2
World Class®	BBT-2



HCW-4 • HCW-5 // Crank & Bottom Bracket Wrenches

Our popular and versatile Crank Wrenches feature our proven "Y" head design.

HCW-4 // 36mm box-end and bottom bracket pin spanner. (Replacement pins-#1501)

HCW-5 // Double sided bottom bracket lockring hook spanner.



RMW-1 // Ratcheting Metric Wrench

A small, quality hand wrench with 8mm and 10mm sockets. Fits many nuts and bolts throughout the bicycle. Useful on brakes, derailleurs, etc. Chrome plated for long, tough use.



CBW-1 • CBW-4 // Metric Wrenches

These small, nickel plated wrenches can be used on brakes, derailleurs, etc.

CBW-1 // 8mm open - 10mm open

CBW-4 // 9mm open - 11mm open

Packaged carded: CBW-1C & CBW-4C



Pin Spanners // SPA-1, SPA-2 & SPA-4

Park Tool Pin Spanners have been designed to give maximum usefulness and versatility at the lowest possible cost. Tough, high carbon steel is used on each tool to ensure long life. Handle is vinyl coated to give a good grip. Each Pin Spanner is color coated for easy recognition.

SPA-1 // Green

Fits adjusting cup on most 3-piece cranks.

Packaged Carded: SPA-1C

SPA-2 // Red

Fits one-key release dust caps and adjusting cone on most freewheels.

Packaged Carded: SPA-2C

SPA-4 // Yellow

Fits adjusting cone on most 1-piece cranks.

Packaged carded: SPA-4C



CCP-2 // Crank Puller

A favorite of shop mechanics for over 30 years, the CCP-2 removes cranks using a square taper, Power Drive®, or Power Spline® bottom bracket interface. A long, comfortable, built-in handle and fine thread provide the leverage needed to remove even the tightest cranks. Designed with a rotating tip to ensure smooth operation and long life.

Packaged carded: CCP-2C



CCP-4 // Crank Puller

The CCP-4 is specifically designed to remove cranks using an Octalink® or ISIS Drive® bottom bracket interface. Uses a comfortable handle, fine thread, and a special rotating tip for superior leverage, smooth operation, and years of trouble-free service.

Packaged carded: CCP-4C



CCW-5 // Crank Bolt Wrench

The CCW-5 features both 14mm socket and 8mm hex wrench on a long, comfortable handle.

Packaged carded: CCW-5C



CWP-6 // Crank Puller & Wrench

The CWP-6 is a compact crank puller with a built-in 8mm hex for crank bolt installation and removal. The universal design includes two rotating tips (11.3mm and 16.3mm), allowing the tool to remove cranks using a square taper, Octalink®, ISIS Drive®, Power Drive®, or Power Spline® bottom bracket interface.

Packaged carded: CWP-6C



CNW-1 // Chainring Nut Wrench

This handy tool fits securely into the slots on the reverse side of a chainring bolt so it doesn't spin when loosening the bolt. Designed specifically for the job, the CNW-1 makes removing chainring bolts much easier.

TAP-7 through TAP-10 // Frame Taps

Frame Taps will become a lifesaver at some time for virtually every mechanic. As with all Park Tool Taps, these are made of high carbon steel and are precision ground. Park Tool Frame Taps cut easily and fit conventional tap handles.



TAP-7 // 3mm x .5 for rear wheel drop-out alignment screws.

TAP-8 // 5mm x .8 for water bottle, toe clip, fender and rack bosses

TAP-9 // 6mm x 1 for cantilever brakes and large fender bosses.

TAP-10 // 10mm x 1 for derailleur hanger.

TAP-3 • TAP-6 // Pedal Taps

Clean out or restore damaged threads in crank arms with these pedal taps. These taps can be used with either steel or alloy crank arms and are available in two popular sizes: 1/2" and 9/16" in both right and left-hand threads. Made of high carbon steel, precision ground, and hardened to stay sharp, they cut easily and fit all conventional tap handles.



Packaged carded: TAP-3C, TAP-6C

TAP-3C Set of 2, 1/2" x 20 Left and Right

TAP-6C Set of 2, 9/16" x 20 Left and Right



Tech Note

Cranks using self-extracting crank bolts do not require a crank puller.



PW-4 // Professional Pedal Wrench

The PW-4 Professional Pedal Wrench is designed for heavy shop use. Two 15mm wrench openings are oriented at 30 degree and 45 degree angles so the user can always achieve the best mechanical advantage, regardless of the pedal position. An oversized, asymmetrical head is made from Cro-Moly steel for superior strength and durability. While strong, the PW-4 is thin enough to access all wrench flats. An extra long 14" handle provides the leverage to remove even the tightest pedals. The handle is round and vinyl dipped so it won't dig into the hand like flat wrenches.



PW-3 // Pedal Wrench

Made from Cro-Moly steel for a shop quality pedal wrench made to last. 15mm and 9/16" precision openings and a long, round, vinyl dipped handle that won't dig into your hand like flat pedal wrenches.



PW-5 // Home Mechanic Pedal Wrench



Designed for the do-it-yourself mechanic or rider the PW-5 is perfect to take along or for the home workshop. Although economically priced, this 15mm pedal wrench, like all Park Tool products is built to last. Made from Heat-treated spring steel and vinyl dipped for comfort, the PW-5 is 11 1/2" (29 cm) long.



Amanda Dalton / Barlows Cycles / St. Austell, United Kingdom



HCW-6, 7, 9, 15 // Headset Wrenches

Our popular and versatile Head Wrenches feature our proven “Y” head design and all headset wrench openings are lazer cut to ensure a tight, accurate fit. Precise sizing is achieved by high voltage computer controlled lazer technology after heat treat. Waiting until the wrench is heat treated eliminates shrinkage and expansion of the steel after the wrench is sized. It takes longer, and costs more, but it’s worth the extra effort.

- HCW-6** // 32mm head wrench & 15mm pedal wrench.
- HCW-7** // 30mm & 32mm head wrench
- HCW-9** // 36mm & 40mm head wrench.
- HCW-15** // 32mm & 36mm head wrench.

HW-2 // Professional Headset Locknut Wrench

Most headset wrenches are too thin to use on the top locknut of headsets, particularly aluminum locknuts which can be marred and rounded off very easily. The HW-2 Professional Headset Locknut Wrench is the answer. It has a thick, semi-box opening and a substantial, extra long handle for a firm and precise grip on most 8 point 32mm and 36mm locknuts. Made of investment cast steel.



Pim Velthuisen / Stappenbelt Bike & Adventure / Apeldoorn, Netherlands



RW-1 • RW-3 // Road Wrenches

An ideal head and pedal wrench to carry along. Small size fits in small bag, or mounts under water bottle cage using slotted center. Nickel plated, heat treated steel.

- RW-1** // 32mm head / 15mm pedal wrench.
 - RW-3** // 36mm head / 15mm pedal wrench.
- Packaged carded: RW-1C, RW-3C



NEW

DT-3 // Rotor Truing Gauge

Accurately gauge the straightness of disc brake rotors while the wheel is mounted in a TS-2 Professional Wheel Truing Stand. The DT-3 features an infinitely adjustable, finely threaded indicator gauge. Works with any diameter brake rotor.



NEW

DT-1 // Disc Mount Facing Tool

In order to ensure disc brakes function smoothly and accurately, the frame's mounting tabs must be parallel with the brake pads and rotor. The DT-1 is designed to perfectly machine the face of each tab, removing paint and material to create a flat surface.



DT-3i // Dial Indicator Set for DT-3

Dial Indicator Kit bolts directly to the DT-3 allowing for greater accuracy and a way to measure results.

NEW



NEW

DT-2 // Rotor Truing Fork

Specially designed, and precisely manufactured to gently adjust bent or damaged brake rotors. Each DT-2 features two different slot depths laser cut from high quality stainless steel. Center handle is vinyl dipped for comfort.

Packaged carded: DT-2C



CN-10 // Professional Cable & Housing Cutter

The CN-10 Cable and Housing Cutter is a shop quality cutter designed specifically for use on all bicycle cables and housing, including hard-to-cut index housing. The CN-10 has cold forged, heat treated steel handles for strength and precision ground cutting jaws for a clean cut on every cable. Dual density molded grips are specially contoured for superior comfort and control. The CN-10 has a built in crimper for cable end caps and a forming hole for reforming housing ends and housing ferrules. A wire latch holds the handles together when not in use.

Packaged carded: CN-10C



OBW-1, 2, 3 // Offset Brake Wrenches

We call these our offset wrenches because of their unique design, which allows them to be used in tight places, such as centering caliper brakes. OBW-1 has 10mm and 13mm openings, OBW-2 has 11mm and 12mm openings. OBW-3 has a 14mm opening, and the other end fits into the tension springs to rotate the brake on its bolt.

Packaged carded: OBW-1C, OBW-2C, OBW-3C



BT-3 // Brake Toe-In Tool

The Brake Toe-In-Tool is used for aligning caliper brake pads in relation to the rim. Brake pads that are perfectly parallel to the rim will "squeal." Park Tool's BT-3 allows pads to be easily "toed-inward."

Simply place tool on flats of caliper arms and gently twist. Hardened, chrome plated chrome-moly with a vinyl coated handle for good grip.



BT-2 // Cable Stretcher

Commonly referred to as a "4th Hand", the Park Tool Cable Stretcher pulls cables tight. It features one-hand operation with a thumb lock to hold the cable tight while your hand is removed to tighten pull-up bolts and nuts. Made from heat treated steel, chrome plated, and featuring cushion grips for comfort. A must for any shop, home or professional.



BT-5 // Adjustable Third Hand Brake Tool

Designed to be used on all brakes, caliper and cantilever. The BT-5 can be used on many different parts of brakes—against shoe, mounting bolt, etc., whatever is more convenient. Squeeze handle and turn knob to lock in place. Chrome plated and vinyl coated to protect the brake finish.



NEW



CL-1 // Synthetic Blend Chain Lube with PTFE

A chain lube from Park Tool, the leader in bicycle maintenance products. Using PTFE and a proprietary blend of oils, Park Tool Chain Lube works great in wet or dry conditions. It penetrates, reduces friction, prolongs component life, displaces moisture, and protects parts from rust and corrosion. Also work great on cables, spoke nipples, and derailleur and brake pivots.

4oz. (118 ml) bottle.

BCB-4 // Bike Cleaning Brush Set

A clean bike looks great, performs better, lasts longer, and is easier to maintain. Now with the BCB-4 Bike Cleaning Brush Set, having a clean bike is easier than ever. The BCB-4 contains four brushes, each specially designed for a specific cleaning purpose: a double-ended gear cleaning brush, a tire and frame tube cleaning brush, a frame cleaning sponge brush, and a tapered detail brush. "Sure Grip" dual density handles insure a positive grip even with wet hands.

Packaged carded: BCB-4

PPL-1 • PPL-2 // PolyLube 1000 Lubricant

Park Tool's poly-urea lubricant was developed specifically for bicycle maintenance and repair. PolyLube 1000 has an extremely high shear strength to protect vital parts under extreme conditions. PolyLube 1000 also repels moisture and is compatible with conventional greases. Available in a handy 4oz. tube (PPL-1) and a 16oz. tub (PPL-2).



FTB-1 // Frame / Fork Tube Brush

All purpose cleaning and scrubbing brush designed to reach where no brush has gone before. The FTB-1 is 35" (89cm) long and features a vinyl dipped shaft and dual density handle for an extra strong grip. Perfect for suspension work, frame tube cleaning, and anything else that needs an extra long brush.

10 Speed Compatible

GSC-1 // GearClean® Brush

Park Tool's patented GearClean Brush has a unique design. A large comfortable handle with a curved, toothed-end reaches dirt deep between the gears, and tough nylon bristles clean the derailleur and chain. Saves wear and tear on your chain and freewheel. Works great on brakes or other places where dirt collects. 10 speed compatible. Handy size to take along for quick cleaning anywhere. Made of sturdy nylon.

Packaged carded: GSC-1C





CM-5 // Cyclone Chain Scrubber

The CM-5 Cyclone Chain Scrubber uses an extra large solvent reservoir and a series of rotating brushes to get chains really clean. A magnet at the bottom of the Cyclone's solvent reservoir draws particles scrubbed from the chain, effectively keeping them from being redistributed on the chain during cleaning. Durable sponge material draws solvent from the chain as it exits the Cyclone, reducing drips and mess. To make it easy to control and use, we've even added a handle. Works with all multi-speed bikes and some single-speed models.

Packaged carded: CM-5

10 Speed Compatible



RBS-5 // CM-5 Rebuild Kit

Packaged carded: RBS-5C



MG-1 // Nitrile Mechanics Gloves

MG-1 Nitrile Gloves keep hands free of grime and protected from potentially harmful chemicals and solvents. MG-1 Nitrile Gloves are thin enough to maintain finger dexterity, yet tough enough to resist snags. They provide superior fit, are easy to slip on and off, and can even be re-used. Sizes M, L, and XL.

Box of 100



10 Speed Compatible

CG-2 // Chain Gang Chain Cleaning System

A dirty drivetrain causes poor shifting and unnecessary wear to expensive parts. The Chain Gang contains everything needed to quickly and easily clean the chain, freewheel cogs, and chainrings. The Chain Gang includes a CM-5 Chain Scrubber, a GSC-1 GearClean® Brush, and an 8 oz. bottle of CB-2 Citrus Chain Brite. The CG-2 works on all derailleur bikes and many 3-speed and coaster brake bikes.



CB-2 // Citrus ChainBrite

Biodegradable Citrus ChainBrite is specially formulated for use in the Cyclone Chain Scrubber. It quickly removes the toughest grease and grime buildup, yet won't harm alloy, plastic or rubber parts. Also works great as a general purpose parts cleaning fluid. Flip-top lid makes pouring easy.

16 oz. (472ml) bottle.





10 Speed Compatible

CT-2 // Plier Type Chain Tool

The CT-2 is designed for fast, easy removal or repair of chains. The tremendous leverage generated removes even the toughest rivets. To use, simply put the chain roller in the built-in recess and squeeze the handles. The travel adjusts to return the rivet back the proper distance. Use CTP replacement pins below.

CT-6 // Folding Chain Tool

The CT-6 works like a heavy duty shop tool, but folds compactly for taking on the road or trail. Features a cast steel body, stainless steel case, replaceable pin (part # 985-1), and a "loosening shelf" for tight links. Works on most derailleur chain (including 10-speed chain)

Packaged carded: CT-6C
Replacement Pins: #985-1C



CT-6 Folded

10 Speed Compatible

CT-5 // Mini Chain Brute Chain Tool

This small chain tool goes anywhere and actually performs like a shop quality tool. The fine thread, special "V"-shaped handle, and super strong replaceable pin make chain removal and installation a breeze. The CT-5 works on any derailleur chain and has a "shelf" for loosening tight links. At only 77 grams, it's the perfect take-along chain tool.

Packaged carded: CT-5C



10 Speed Compatible

CTP // Replacement Chain Tool Pin

These pins (not shown), fit Park Tool's CT-1, CT-2, CT-3 and CT-7 Chain Tools. Made from hardened alloy tool steel.

Packaged carded in pairs: CTP-C

CTP-5 // Replacement Chain Tool Pin

These pins (not shown), fit Park Tool's CT-5 Mini Chain Brute Chain Tool. Made from hardened alloy tool steel.

Packaged carded in pairs: CTP-5C

CT-3 // Screw Type Chain Tool

Because of the tremendous force needed to remove chain pins, our Screw Type Chain Tool is made from investment cast steel. Along with superior strength and durability, the CT-3 features a handy "loosening shelf" to remedy stiff links after reassembly. The fine thread and comfortable size enable easy removal of even the toughest chain pins. Like all Park Tool Chain Tools, it's easy to use and built to last.

Now packaged for retail sales



10 Speed Compatible

CT-7 // Screw Type Chain Tool

The CT-7 Chain Tool is specifically designed to work on the wide and tall 3/16" BMX/freestyle chains now becoming popular. The CT-7 also works on 1/8" BMX/freestyle chains. Made from investment cast steel for strength and durability, the CT-7 has a replaceable driving pin (part CTP), a fine thread, and a comfortable handle. Please note: The CT-7 will not work on 3/32" derailleur or 3/32" BMX chains.



10 Speed Compatible

MLP-1 // Master Link Pliers

Many derailleur chains use a "master link" that allows the chain to be installed and removed by hand. While this type of masterlink doesn't require a traditional chain tool, over time, dirt and corrosion can make it difficult to separate by hand. MLP-1 Master Link Pliers make removal and replacement of these masterlinks quick and effortless. Simply insert the specially sized jaws into the masterlink and squeeze the handles.

Packaged carded: MLP-1C



10 Speed Compatible

CC-3 // Chain Wear Indicator

A worn chain shifts poorly and wears sprockets at an accelerated rate. The CC-3 is a "go, no go" gauge designed to accurately indicate when a chain reaches .75% and 1% wear, the points at which most chain manufacturers suggest replacement. Made from precision, laser cut steel.

Packaged carded: CC-3C



10 Speed Compatible



CC-2 // Chain Checker

To alleviate poor shifting and uneven drive train wear, most manufacturers recommend chain replacement at or before 1% stretch. Now you can quickly and accurately determine the wear and stretch of any chain with the Park Tool Chain Checker. Simply insert the Chain Checker's pins into two links, press the swing arm gauge tight, and then check the gauge window for an accurate reading.

Packaged carded: CC-2C

10 Speed Compatible



BTS-1 // Bottom Bracket Tapping & Facing Set

The BTS-1 is a precision tool system which provides a piloted means of tapping the threads in the bottom bracket shell of a frame. After tapping, the taps act as guides to keep the included facing cutter perfectly square with the axis of the bottom bracket for cleanup of the faces of the bottom bracket shell. The BTS-1 includes English taps, 1.370" x 24 TPI right hand thread for the adjustable cup, and 1.370" x 24 TPI left hand thread for the fixed cup. Italian thread taps, 36mm x 24 TPI right hand thread (Part #693), for the adjustable and fixed cups are available as accessories.

Replacement facer (Part #690) available.

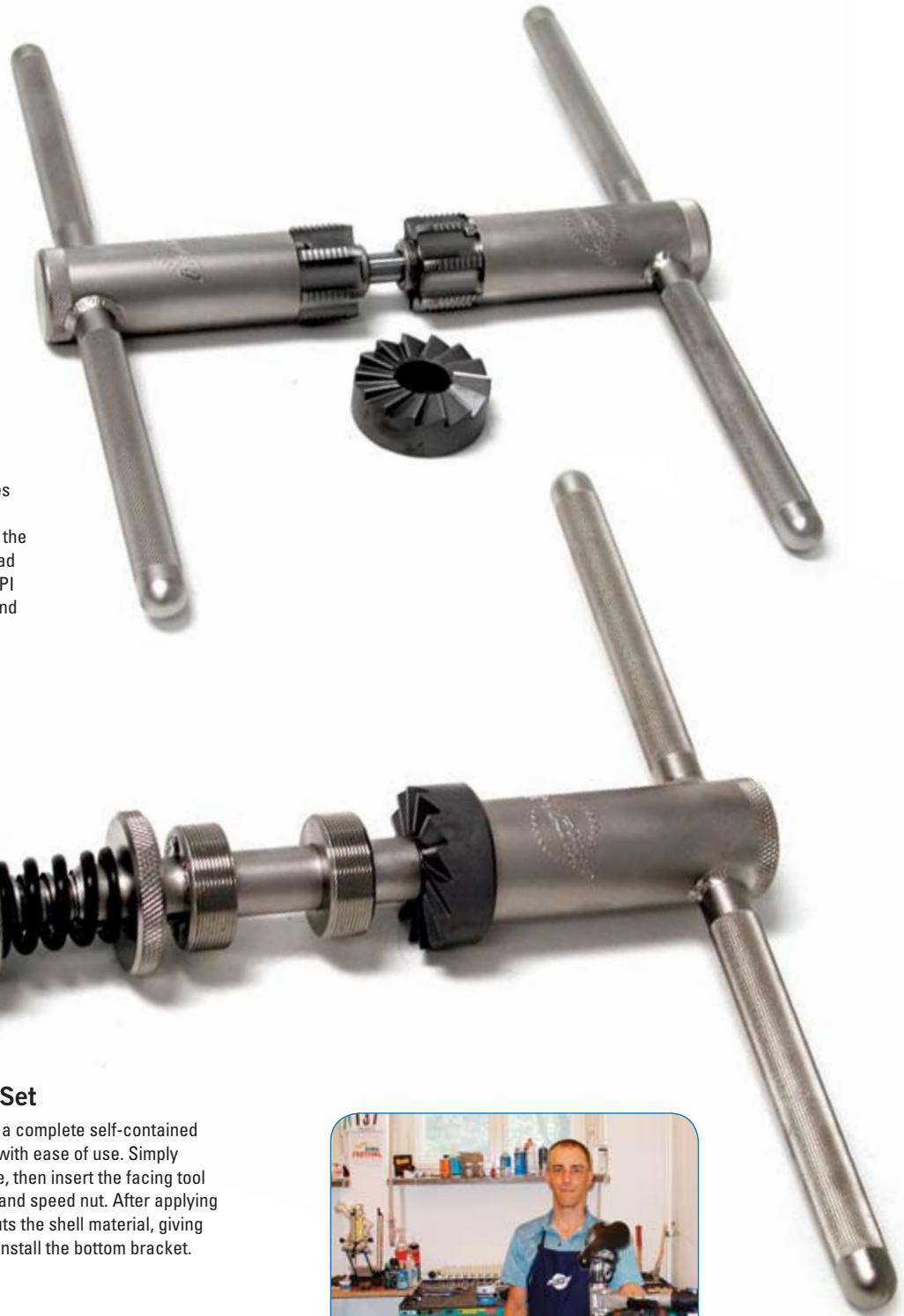

BFS-1 // Bottom Bracket Facing Set

The Bottom Bracket Facing Set is designed to be a complete self-contained facing set, combining top quality precision parts with ease of use. Simply install the threaded inserts using the facer handle, then insert the facing tool through the guides and install the tension spring and speed nut. After applying a liberal amount of cutting oil, the BFS-1 easily cuts the shell material, giving you a clean, faced surface. Now you're ready to install the bottom bracket.

Replacement facer (Part #690) available.

Tech Note

The BFS-1 uses a powerful spring that can apply significant pressure to the #690 facer. The BTS-1 relies on hand pressure to face the shell. The BFS-1 is useful for frame builders and others who need to remove large amounts of metal from the shell, while the facing feature of the BTS-1 is useful for "cleaning up" minor amounts of paint and metal from the face of the bottom bracket.



Kai Frommelt / Bike Kult / Berlin, Germany



HTR-1B // Head Tube Reaming & Facing Set

HTR-1B Includes 33.8mm reamer in place of 30.0 reamer.

HTR-1 // Head Tube Reaming & Facing Set

Proper frame preparation is very important. The HTR-1 combines reaming and facing of the head tube to create a perfect fit for most sizes of head cups. The HTR-1 comes complete with a 30.0mm reamer, and four different size pilots, (29.8mm, 30.0mm, 33.8mm, and 36.8mm). There are cases when a reamer is required to clean out or increase the diameter of the head tube. Most times however, facing of the head tube for good cup fit is the objective. In this case, reaming is not necessary and the pilots can be used in place of the reamers to keep the tool straight and create a faced head tube. The unique part of the HTR-1 is the quick-release, quick-adjust feature. The bottom portion can slide off and on easily without the long threading process. This portion of the tool can still be fine tuned while in use. The tapered centering cone unit rides on a bearing for extra smooth operation. All cutting surfaces are top quality and extra sharp.

// Additional Reamers & Facers Available For Use With HTR-1:

- 751 //** 30.0 mm Reamer. Reams head tubes using 1" headsets.
- 754 //** 33.8 mm Reamer. Reams head tubes using 1-1/8" headsets.
- 755 //** 36.8 mm Reamer. Reams head tubes using 1-1/4" headsets.
- 769 //** Head Tube Reamer Extension. Extends reaming depth of 751, 754 and 755 Reamers up to 27mm for head tubes using deep insertion headset cups.
- 690 //** Facing Cutter. Faces head tubes using 1", 1-1/8", and 1-1/4" headsets.
- 690-XL //** Facing Cutter. Faces head tubes using "low profile" (integrated with cups) headsets, such as Cane Creek ZeroStack and others. Used with 768 Pilot and 750 Centering Cone Adaptor.
- 756S //** Reaming and Facing Cutters. Reams and faces head tubes using "integrated" headsets with a 41mm bearing and 45 degree angular contact, such as Cane Creek IS and others. Includes upper and lower cutters. Used with 750 Centering Cone Adaptor.
- 758 //** Reaming and Facing Cutter. Reams and faces head tubes using "OnePointFive" headsets. Used with 750 Centering Cone Adaptor.
- 761S //** Reaming and Facing Cutters. Reams and faces head tubes using "integrated" headsets with a 42mm bearing and 45 degree angular contact, such as Campagnolo and others. Includes upper and lower cutters. Used with 750 Centering Cone Adaptor.
- 768 //** 43.8 mm Pilot. Required when facing head tubes using "low profile" (integrated with cups) headsets, such as Cane Creek Zero Stack and others. Used with 690XL Facing Cutter and 750 Centering Cone Adaptor.
- 750 //** Centering Cone Adaptor. Adapts centering cone on HTR-1 for use on "low profile", "integrated", and "OnePointFive" headsets.



CRC-1 // Crown Race Cutting Tool

To insure proper headset performance and longevity, special attention must be given to accurately machine the fork's crown race seat. The CRC-1 is a professional quality machining tool for milling both the outer edge and lower surfaces of the crown race seat. A unique adjusting system allows a tight fit of the tool on any fork, threaded or unthreaded (even forks with externally butted steerer tubes), ensuring a smooth, accurate cut and proper alignment of the fork in the frame. The CRC-1 Crown Race Cutting Set includes high speed steel cutters and adjustable collets to machine 26.5mm and 27.1mm crown race seats on 1" forks and 30.1mm crown race seats on 1-1/8" forks.



NEW



HHP-3 // Home Mechanic Head Cup Press

Simple and economical, the HHP-3 is designed to install all sizes of head cups and one-piece bottom bracket cups.

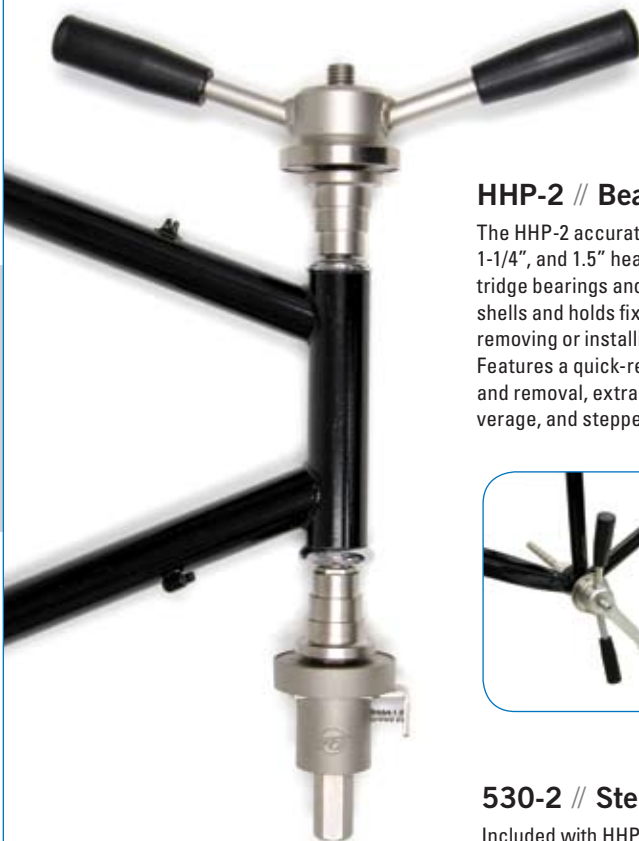

HHP-2 // Bearing Cup Press

The HHP-2 accurately aligns and presses 1", 1-1/8", 1-1/4", and 1.5" headset cups. In addition, it presses cartridge bearings and cups into one-piece bottom bracket shells and holds fixed cup wrenches firmly in place when removing or installing adjustable-type bottom brackets. Features a quick-release design for fast tool installation and removal, extra long (30cm) handles for superior leverage, and stepped bushings for precise cup alignment.



530-2 // Step Bushing Cup Adaptors

Included with HHP-2, also available separately in pairs

Tech Note

Park Tool bottom bracket and headset cutting facers, reamers and taps are made from high-speed tool steel. Apply generous amount of machining cutting fluid, such as Park Tool CF-1, often during use. Do not allow cutting tools to bang or strike other tools, as this may damage cutting surface, and keep cutting tools clean. With use, the cutting edge will dull and require re-sharpening. While there are many variables that play a role in how long a cutting tool will stay sharp (e.g. technique used, amount and type of lubrication used, type of material being machined, etc.), in general, have the tools re-sharpened once a year. Tools can be re-sharpened by The Tool Grinder (805.546.1331), a service that specializes in sharpening cutting tools for the bike industry, or by a local industrial tool grinding company.



SG-6 // Threadless Saw Guide

The SG-6 Threadless Saw Guide ensures a straight, clean cut on 1", 1-1/8", and 1-1/4" threadless forks. Simply clamp the SG-6 onto the fork and cut, letting the SG-6 guide the hacksaw blade. The SG-6's non-scratching composite body incorporates steel threads and a steel reinforcing plate to withstand the rigors of heavy shop use.

CF-2 // Park Tool Cutting Fluid

The use of cutting oil or cutting fluid is extremely important when performing any cutting, tapping, facing, or reaming operation. Park Tool Cutting Fluid is a high quality, environmentally safe cutting fluid that extends tool life and makes any frame prep job easier and safer. Park Tool Cutting Fluid can effectively be used on all metals.

8 oz. (237 mL) bottle.



SG-1 • SG-2 // Threaded Saw Guides

Cut any fork quickly and easily with these handy fork stack cutting guides. Heat treated for long life, each guide cleans the freshly cut threads upon removal so headset parts install easily. Cut as little as 1mm from any fork.

- SG-1 // 1" cutting guide
- SG-2 // 1-1/8" cutting guide



RT-1 • RT-2 // Head Cup Remover

The Park Tool Head Cup Remover makes headset cup removal easy. The tool is pulled through the frame until the flared ends snap in behind the cup. A blow on the tool head removes the cup. Strong, heat treated alloy steel with nickel finish.

RT-1 // Fits 1", 1 1/8", 1 1/4" as well as some low profile and internal head cups.

RT-2 // Fits 1 1/4" and 1.5" head cups as well as some low profile and internal head cups.



TNS-1 // Threadless Nut Setter

The Threadless Nut Setter is used to install the star-fangled nut found on 1" and 1-1/8" threadless headset systems. Thread the nut onto the TNS, insert into the fork stack, and tap it in with a hammer. Sets the star-fangled nut to 15mm and keeps it straight. Long handle helps prevent pinched fingers.

Uses Part #822 Replacement Set Screws.



CRP-1 // Universal Crown Race Puller

The CRP-1 is a precision tool for quickly and easily removing the headset crown race from the crown race seat of the fork. Universal design works with 1", 1-1/8", 1-1/4" and 1.5 crown race/fork (suspension or rigid) combinations. To use, simply turn the two small T-handles to press the thin-edged wedges under the crown race. Then turn the large T-handle to completely pull the crown race from the fork. No more hammer and punch! All steel construction for long life.

Replaceable wedges (part #1170-2, two required).

#838 // Crown Race Setting Ring

Used in conjunction with the CRS-1 Crown Race Setting System to install the special crown race used on 1-1/8" and 1-1/16" Klein Aeros and Trek Superlight Composite Forks.



Paul Damato / University Bicycles / Boulder, Colorado



CRS-1 // Crown Race Setting System

We've taken a fresh new approach to crown race installation. Traditionally, a mechanic would slam a tube down onto the bearing surface to "set" the race in place. The CRS-1 offers a different approach that offers faster, safer, and more precise installation. The bearing surface is spared a direct hit by using different inserts to ensure proper fit on the race. Choose the correct insert then slide the tube over the fork tube and into the top end of the insert. Using a hammer, tap firmly on the end cap of the tube and seat the race into its proper place safely and accurately. The CRS-1 set includes one universal setting tube, three 1" inserts, and three 1-1/8" inserts.



FTS-1 // Fork Threading Set

The FTS-1 Fork Threading Set is designed for cutting new threads and for chasing existing threads on fork columns that are not chromed. The FTS-1's expandable cutting dies are made from the highest quality high speed steel for precision cutting and long life. The unique thread guide system used with the FTS-1 is specially designed to allow the metal chips and shavings that result during use to fall completely through the guide, preventing damage to the fork threads and the tool. The FTS-1 includes die handles, 1" x 24 tpi cutting die (Part #606), and 1" cutting guide (Part #610). 1-1/8" x 26 die (Part #607), 1-1/4" x 26 die (Part #608), 1-1/8" guide (Part #611), and 1-1/4" guide (Part #612) are available as accessories. Die handles fit all three sizes of dies and guides.





DAG-1 // Derailleur Hanger Alignment Gauge

The Derailleur Hanger Alignment Gauge can help solve a multitude of derailleur shifting problems, most notably with index shifting systems. This tool is extremely steady in operation and is simple to use. The tool threads directly into the derailleur hanger. The gauge bar holds a gauge which marks the distance to the wheel. The gauge then is rotated with the wheel to the 3, 6, 9, and 12 o'clock positions, noting any differences in measurements. The alignment of the derailleur hanger is accomplished by applying pressure to the tool's arm. The results can be checked instantly. The DAG-1 is made of heavy-gauge steel and is chrome plated for long shop life.

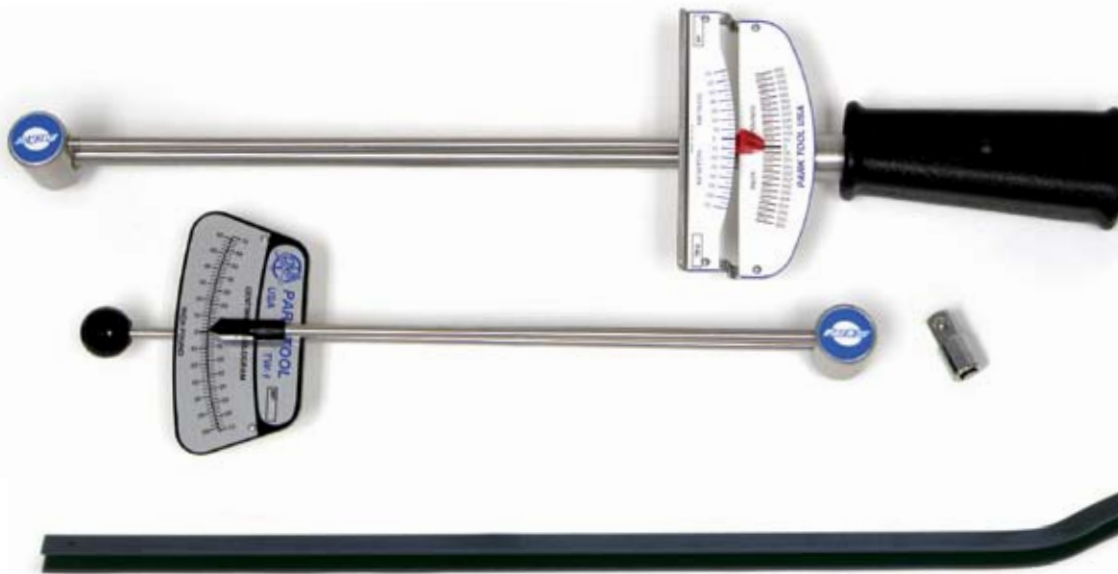

TW-1 • TW-2 // Torque Wrenches

Because torque specifications are now given for most parts and accessories, Park Tool offers two tough, accurate torque wrenches. The TW-1 is 1/4" drive (includes 3/8" adaptor) and ranges from 0-60 inch pounds with compatible metric equivalents. The TW-2 is 3/8" drive and ranges from 0-600 inch pounds.



FAG-2 // Frame Alignment Gauge

Many bicycles will not shift or track properly because the front and rear wheels are not in line with the frame. If these conditions still exist after wheel and derailleur adjustments, the seat stays, chain stays, and rear drop-outs of the frame may be misaligned. For years the accepted method to check the alignment of the rear drop-out was to run a string on either side. This method does work to some extent. However, it is not accurate because the measurement is not taken at the drop-out. With the Park Tool Frame Alignment Gauge the alignment can be checked quickly and accurately at the drop-out. Retractable pointer to fit all sizes and types of bicycles.



KS-1 // Kickstand Tool

The KS-1 quickly and easily removes and installs Schwinn-type built-in kickstands (also called "Sprague" kickstands).

// Frame & Fork Straightening Tools

This section is devoted to our frame and fork straightening tools. Many bicycles cannot be properly repaired or adjusted because their frames and forks are no longer true. With the high cost of new bicycles and replacement frames and forks, straightening can be a viable, cost-effective alternative. Many damaged bicycles can be safely straightened and repaired when the proper tools are used by skilled mechanics. When these tools are used to straighten and assure the alignment of a frame or fork, the repaired bicycle will be safer to ride.

CAUTION

During any repair, safety should always come first. Customers should be advised prior to straightening that not all bicycles can be repaired. After alignment, all frames and forks should be carefully inspected for cracks or kinked tubes. A customer should be advised when certain conditions render a bicycle unsafe to ride.

Updated



FFS-2 // Frame and Fork Straightener

The Park Tool Frame and Fork Straightener is a versatile and productive tool. The open hook design enables it to straighten not only frames and forks, but also cranks and handlebars. Vinyl coating on the hook and on the fulcrum pad protects painted surfaces. The hook has over 8" of adjustment. Reinforced to prevent flexing. The adjustable hook now accommodates a fork or tube up to 1 3/4" (44mm) in diameter – 35% larger than that of the FFS-1 – and features over 8" (20.3 cm) of sliding travel adjustment.



FFG-1 // Frame & Fork End Alignment Gauge Set

There are occasions, even on new bikes, when the frame and fork drop-outs are not parallel, creating bent axles or skewers, poor tracking, and even problem shifting. The Park Tool Frame and Fork Alignment Gauge Set was designed to align the drop-outs easily without elaborate fixtures. They quickly show whether the drop-outs are parallel and produce plenty of leverage to straighten them. These Park Tool gauges adjust to compensate for various hub widths. A caliper is provided for checking this dimension.

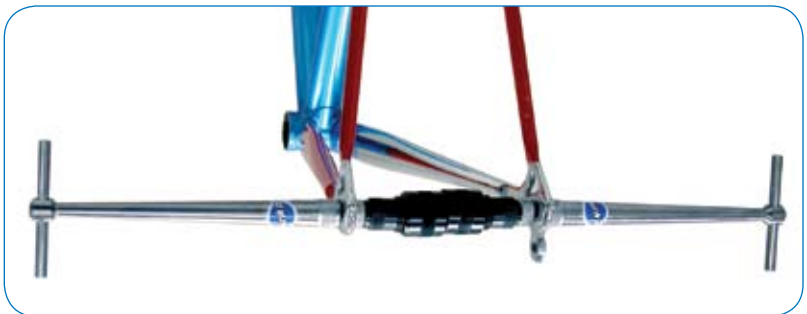

Tech Note

The FFG-1 is designed for dropouts using 10mm or smaller axles. Attempting to bend oversized axle dropouts may damage the tool.



PPF-3 included

PDR-4 // Park Tool Display System

"The Right Tool for the Job". Over 4,000 bike shop owners worldwide rely on Park Tool Displays to help sell tools. And now, the newly updated PDR-4 Park Tool Display Center makes it easier than ever. A brand new mix of tools for maintaining most bikes, attractive new packaging and graphics, a copy of our Home Mechanic Tool Selection Guide, and a versatile display that can be easily rolled from one location in the shop to another. It all adds up to create an impressive, well-defined tool and information center that sends your customers the message they've come to the right place for all their bicycle tool needs. If you're serious about selling bicycle tools, the updated PDR-4 Park Tool Display System is the right tool for the job.



PDR-5 // Mini Wall Display

If you don't have the space for a full display system, check out the PDR-5 Mini Wall Display. It's a great way to get your feet wet and to discover how profitable selling tools can be.



STL-2 // Rolling, Adjustable Height Shop Stool

The new STL-2 is ideal for quickly maneuvering around the bike while making adjustments. It has an adjustable gas shock with 5" (13cm) of travel, smooth-rolling wheels, and a swiveling seat with a three-color Park Tool Logo. Adjusts in height from 17" to 22" (44cm to 57cm).



STL-1 // Shop Stool

The STL-1 Park Tool Shop Stool has chrome-plated steel legs and a comfortable padded seat with a three-color Park Tool Logo. The seat swivels 360 degrees and is positioned at a height of 32" (81cm)—the perfect height for wheel truing or other work at a bench or counter. Great in the shop or on the sales floor.



TP#2 // Toilet Paper Holder

The TP#2 features a TIG welded steel frame, ball bearing headset, chrome finish, and a quick release skewer for fast roll changes. The perfect accessory for the home or shop bathroom.



SA-1 // Shop Apron

Protect your clothes and gain the advantage of large pouch pockets whenever you work in the shop. Our full-length, shop quality aprons are made of a heavy 7-ounce poly cotton twill for comfort and durability. Navy blue with white embroidered Park Tool logo.



SA-3 // Heavy Duty Shop Apron

Once you try on this apron, there's no going back to standard aprons. The SA-3 is made from heavy 10 oz. cotton canvas and has two rows of bar tack reinforced pockets for stashing pens, parts, tools, etc. The special crossback design removes pressure from the neck for all day comfort. A nylon quick release makes the apron easy to adjust and take off. A full 35" in length, the bottom 7" of the apron can be snapped up for a custom height fit. An embroidered Park Tool logo makes the apron as good looking (even when it's dirty) as it is functional.



MS-1 // Mechanic's Shirt

The MS-1 Mechanic's Shirt is an oversized version of the traditional mechanic's shirt. It has two pockets and is made from a wrinkle-free 65% poly/35% cotton blend for long wear and good looks. Sizes M, L, XL, and XXL.

MUG-1 // Coffee Mug

There's nothing better than a steaming cup of java to start your day. And there's no better place to put that java than in a black ceramic Park Tool mug. Both sides of the mug feature the Park Tool logo in blue and white.

BLT-1 // Spoke Wrench Belt

With a buckle modeled after our world famous spoke wrench design, the new BLT-1 Spoke Wrench Belt is the perfect compliment to the wardrobe of any cyclist or mechanic. The buckle is made from investment cast stainless steel and the belt is woven nylon. One size fits waists up to 48".

PZT-1 // Big Wheel™ Pizza Tool®

What bike shop would be complete without a good pizza cutter? The PZT-1 just happens to be a top-quality pizza cutter that looks like a high-wheeler. No hidden use, just a pizza cutter. Available only in the world famous "Park Tool Blue". Comes complete with display stand and gift box.

HAT-1 // Ball Cap

Our cap features an embroidered Park Tool logo and an adjustable backstrap.

TSL-1B • TSH-1 // T-Shirt

Our cotton T-shirts are pre-shrunk and feature an extra large, two-color logo. Sizes M, L, XL, and XXL.

BO-1 // Bottle Opener

Packaged carded: BO-1C

PNT-1 // Pint Glass

Featuring a three color Park Tool logo, the PNT-1 Pint Glass is made from heavyweight, dish-washer safe glass.



PC-1 • PC-2 // Shop Clock

These two wall clocks will dress up any shop. The PC-1 features a real rubber tire, chrome rim, two color logo, quartz mechanism, and back-lit face (110v outlet and AA battery required.) The PC-2 is an unlit version. It uses the same face, tire, rim, and mechanism - just no light.